



LEGEND

-  FILL AREAS
-  CUT AREAS
-  OVERLAND FLOW PATH

NOTES

1. ALL EXISTING SERVICES UNDER NEW PAVEMENTS, PATHS AND VEHICLE CROSSINGS TO BE BACKFILLED WITH FCR.
2. ALL EXISTING PITS AND MANHOLES WITHIN NEW WORKS TO BE ADJUSTED TO NEATLY MATCH NEW FINISHED SURFACE.
3. EXISTING FENCES ALONG TIMBERTOP BOUNDARY AFFECTED BY WORKS TO BE REINSTATED TO THE OWNERS SATISFACTION.
4. ALL EXISTING SEWER PROPERTY BRANCHES AND HOUSE DRAINS DAMAGED BY WORKS TO BE REPLACED BY CONTRACTOR.
5. ALL EXISTING OPEN DRAINS TO BE DRAINED, DESLUDGED AND BACKFILLED TO LEVEL 1 REQUIREMENTS.

NOTE

ALL RADII AND LEVELS ARE TO LIP OF KERB UNLESS OTHERWISE NOTED. ALL LINEMARKING AND SIGNAGE ARE TO BE IN ACCORDANCE WITH AS1742.2 - 1994. LINEMARKING SETOUT SHALL BE INSPECTED AND APPROVED BEFORE FINAL LINEMARKING IS CARRIED OUT.

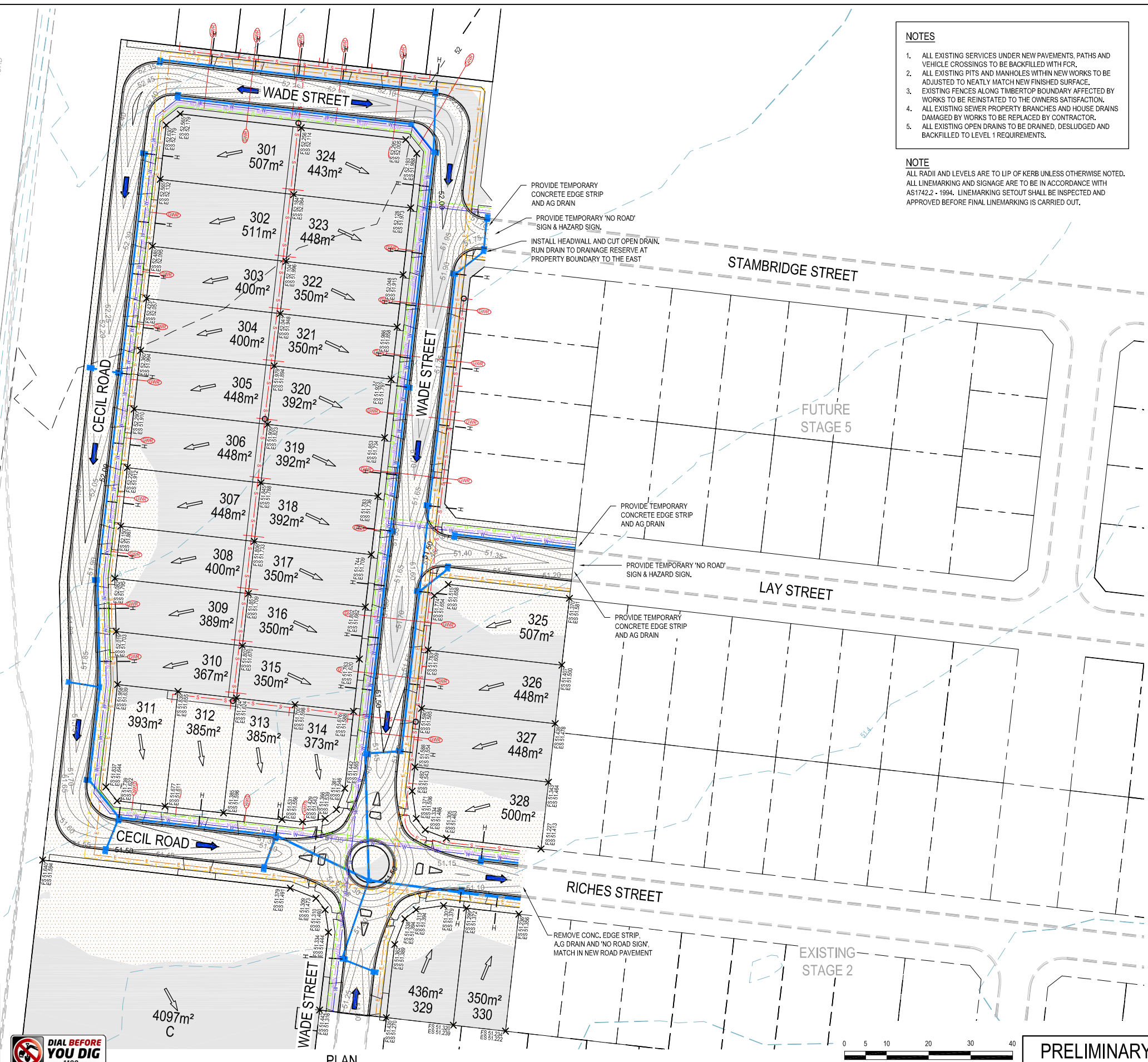

WARNING
BEWARE OF UNDERGROUND SERVICES
THE LOCATIONS OF UNDERGROUND SERVICES ARE APPROXIMATE ONLY AND THEIR EXACT POSITION SHOULD BE PROVIDED ON SITE. NO GUARANTEE IS GIVEN THAT ALL EXISTING SERVICES ARE SHOWN. A MOC'S ENQUIRY ON 1100 MUST BE MADE BY THE CONTRACTOR PRIOR TO COMMENCEMENT OF WORKS.

WARNING
IT IS THE RESPONSIBILITY OF THE CONTRACTOR TO VERIFY THE SETOUT INFORMATION PROVIDED ON THIS PLAN WITH THE DESIGN INTENT WHICH INCLUDES, BUT IS NOT LIMITED TO ITEMS SUCH AS LENGTHS, CO-ORDINATES, SETOUT DIMENSIONS AND PEGGED TITLES BY THE PRINCIPAL'S LICENSED SURVEYOR.

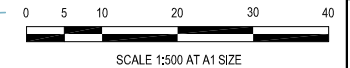

PRELIMINARY
NOT FOR CONSTRUCTION

<p>TAYLORS Urban Development Built Environments Infrastructure Civil Engineering Project Management 8 / 270 Ferntree Gully Road, Notting Hill, Victoria, 3148 Tel: +61 3 9591 2800 Web: taylorsonline.com.au</p>		<p>WYNDHAM CITY COUNCIL EMERALD PARK STAGE 3 DETAIL LAYOUT PLAN</p>		<p>SCALE 1:500 @ A1, 1:1000 @ A3 VERSION A SHEET 7 OF 22 DRAWING No. 12332-3-E-106</p>	
DESIGNED: TNO	AUTHORISED: JOY	TAYLORS REF: 12332-3-E			
CHECKED: AHM	AUTH. DATE: -	CAD REF: 12332-3-E-106			

VER	DATE	REVISION	APPD.
A	04.05.2016	ISSUED FOR COUNCIL APPROVAL	TNO

Existing Gas Main	ExG	Proposed Drain & Pit	DP
Existing Water Main	ExW	Proposed Property Inlets	PI
Existing Electricity Cable	ExE	Proposed Sewer Main & M.H.	SM
Existing Telco Cable & PB	ExT	Proposed Gas & Water Conduit	GC
Existing Sewer Main & M.H.	ExS	Proposed Water main	WM
Existing Drain & Pit	ExD	Street Name Sign	NS
Existing Property Inlet	ExI		
Existing Open Earth Drain	ExO		

P.S.M.	T.B.M.
Open Drain	
Existing surface level	178.34
Finished surface building line & road reserve	F213.45
Finished surface top of batter	B135.39
Pavement level	P129.37
Filling on lots deeper than 200mm	
Fly Service	FS

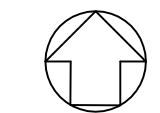

Coords: MGA Levels: AHD