



---

## FILL CERTIFICATE

PROJECT: Lot No 402 (as per Drawing No 12332-4-E-107)  
Emerald Park Estate (Stage 4), Tarneit

CLIENT: Winslow Constructors Pty Ltd  
50 Barry Road  
CAMPBELLFIELD VIC 3061

REPORT NO: 18416\_402

DATE: 16 July 2019

---

## SUMMARY

Civil Geotechnical Services were engaged by Winslow Constructors Pty Ltd to provide inspection and testing services on the earthworks associated with the construction of Lot 402 of the Emerald Park Estate (Stage 4), Tarneit in a manner which would satisfy the criteria for Level 1 testing and inspection services as specified in Section 8.2 of AS 3798 - Guidelines on earthworks for commercial and residential developments (2007). The project was classified as Type 1/2 requiring a minimum density ratio of 95.0% (standard compactive effort) within the areas of fill placement.

A site inspection was conducted prior to any fill being placed on the Lot. On the completion of the earthworks and after examining the test results and the materials used, we are of the opinion that the filling procedure conducted by Winslow Constructors Pty Ltd satisfied the requirements of the Level 1 criteria specified in AS 3798 in regard to the placement of fill on a Type 1/2 Project.

Accordingly, when classifying the site in accordance with the procedures presented in Section 2 of AS 2870 – Residential slabs and footings (2011), we are of the view that the bulk fill materials that were placed over this Lot by Winslow Constructors Pty Ltd can be considered as having been placed in a controlled manner to a minimum density ratio of 95% (standard compactive effort). As such, the bulk fill materials would be deemed to be controlled fill that complies with Clause 1.8.13 of AS 2870. Hence, re-classification of the site to account for the fill presence is permitted under Clause 2.5.3 (c) of AS 2870.

## LIMITATIONS

The use of this Certificate is only appropriate for the field conditions present up to 21 November 2018.

A handwritten signature in blue ink, appearing to read 'Nick Brock', is written over a light blue circular stamp.

Nick Brock



---

## FILL CERTIFICATE

PROJECT: Lot No 403 (as per Drawing No 12332-4-E-107)  
Emerald Park Estate (Stage 4), Tarneit

CLIENT: Winslow Constructors Pty Ltd  
50 Barry Road  
CAMPBELLFIELD VIC 3061

REPORT NO: 18416\_403

DATE: 16 July 2019

---

## SUMMARY

Civil Geotechnical Services were engaged by Winslow Constructors Pty Ltd to provide inspection and testing services on the earthworks associated with the construction of Lot 403 of the Emerald Park Estate (Stage 4), Tarneit in a manner which would satisfy the criteria for Level 1 testing and inspection services as specified in Section 8.2 of AS 3798 - Guidelines on earthworks for commercial and residential developments (2007). The project was classified as Type 1/2 requiring a minimum density ratio of 95.0% (standard compactive effort) within the areas of fill placement.

A site inspection was conducted prior to any fill being placed on the Lot. On the completion of the earthworks and after examining the test results and the materials used, we are of the opinion that the filling procedure conducted by Winslow Constructors Pty Ltd satisfied the requirements of the Level 1 criteria specified in AS 3798 in regard to the placement of fill on a Type 1/2 Project.

Accordingly, when classifying the site in accordance with the procedures presented in Section 2 of AS 2870 – Residential slabs and footings (2011), we are of the view that the bulk fill materials that were placed over this Lot by Winslow Constructors Pty Ltd can be considered as having been placed in a controlled manner to a minimum density ratio of 95% (standard compactive effort). As such, the bulk fill materials would be deemed to be controlled fill that complies with Clause 1.8.13 of AS 2870. Hence, re-classification of the site to account for the fill presence is permitted under Clause 2.5.3 (c) of AS 2870.

## LIMITATIONS

The use of this Certificate is only appropriate for the field conditions present up to 21 November 2018.

A handwritten signature in blue ink, appearing to be 'Nick Brock', is written over a light blue circular stamp.

Nick Brock



---

## FILL CERTIFICATE

PROJECT: Lot No 404 (as per Drawing No 12332-4-E-107)  
Emerald Park Estate (Stage 4), Tarneit

CLIENT: Winslow Constructors Pty Ltd  
50 Barry Road  
CAMPBELLFIELD VIC 3061

REPORT NO: 18416\_404

DATE: 16 July 2019

---

## SUMMARY

Civil Geotechnical Services were engaged by Winslow Constructors Pty Ltd to provide inspection and testing services on the earthworks associated with the construction of Lot 404 of the Emerald Park Estate (Stage 4), Tarneit in a manner which would satisfy the criteria for Level 1 testing and inspection services as specified in Section 8.2 of AS 3798 - Guidelines on earthworks for commercial and residential developments (2007). The project was classified as Type 1/2 requiring a minimum density ratio of 95.0% (standard compactive effort) within the areas of fill placement.

A site inspection was conducted prior to any fill being placed on the Lot. On the completion of the earthworks and after examining the test results and the materials used, we are of the opinion that the filling procedure conducted by Winslow Constructors Pty Ltd satisfied the requirements of the Level 1 criteria specified in AS 3798 in regard to the placement of fill on a Type 1/2 Project.

Accordingly, when classifying the site in accordance with the procedures presented in Section 2 of AS 2870 – Residential slabs and footings (2011), we are of the view that the bulk fill materials that were placed over this Lot by Winslow Constructors Pty Ltd can be considered as having been placed in a controlled manner to a minimum density ratio of 95% (standard compactive effort). As such, the bulk fill materials would be deemed to be controlled fill that complies with Clause 1.8.13 of AS 2870. Hence, re-classification of the site to account for the fill presence is permitted under Clause 2.5.3 (c) of AS 2870.

## LIMITATIONS

The use of this Certificate is only appropriate for the field conditions present up to 21 November 2018.

A handwritten signature in blue ink, appearing to read 'Nick Brock', is written over a light blue circular stamp.

Nick Brock



---

## FILL CERTIFICATE

PROJECT: Lot No 405 (as per Drawing No 12332-4-E-107)  
Emerald Park Estate (Stage 4), Tarneit

CLIENT: Winslow Constructors Pty Ltd  
50 Barry Road  
CAMPBELLFIELD VIC 3061

REPORT NO: 18416\_405

DATE: 16 July 2019

---

## SUMMARY

Civil Geotechnical Services were engaged by Winslow Constructors Pty Ltd to provide inspection and testing services on the earthworks associated with the construction of Lot 405 of the Emerald Park Estate (Stage 4), Tarneit in a manner which would satisfy the criteria for Level 1 testing and inspection services as specified in Section 8.2 of AS 3798 - Guidelines on earthworks for commercial and residential developments (2007). The project was classified as Type 1/2 requiring a minimum density ratio of 95.0% (standard compactive effort) within the areas of fill placement.

A site inspection was conducted prior to any fill being placed on the Lot. On the completion of the earthworks and after examining the test results and the materials used, we are of the opinion that the filling procedure conducted by Winslow Constructors Pty Ltd satisfied the requirements of the Level 1 criteria specified in AS 3798 in regard to the placement of fill on a Type 1/2 Project.

Accordingly, when classifying the site in accordance with the procedures presented in Section 2 of AS 2870 – Residential slabs and footings (2011), we are of the view that the bulk fill materials that were placed over this Lot by Winslow Constructors Pty Ltd can be considered as having been placed in a controlled manner to a minimum density ratio of 95% (standard compactive effort). As such, the bulk fill materials would be deemed to be controlled fill that complies with Clause 1.8.13 of AS 2870. Hence, re-classification of the site to account for the fill presence is permitted under Clause 2.5.3 (c) of AS 2870.

## LIMITATIONS

The use of this Certificate is only appropriate for the field conditions present up to 21 November 2018.

A handwritten signature in blue ink, appearing to read 'Nick Brock', is written over a light blue circular stamp.

Nick Brock



---

## FILL CERTIFICATE

PROJECT: Lot No 406 (as per Drawing No 12332-4-E-107)  
Emerald Park Estate (Stage 4), Tarneit

CLIENT: Winslow Constructors Pty Ltd  
50 Barry Road  
CAMPBELLFIELD VIC 3061

REPORT NO: 18416\_406

DATE: 16 July 2019

---

## SUMMARY

Civil Geotechnical Services were engaged by Winslow Constructors Pty Ltd to provide inspection and testing services on the earthworks associated with the construction of Lot 406 of the Emerald Park Estate (Stage 4), Tarneit in a manner which would satisfy the criteria for Level 1 testing and inspection services as specified in Section 8.2 of AS 3798 - Guidelines on earthworks for commercial and residential developments (2007). The project was classified as Type 1/2 requiring a minimum density ratio of 95.0% (standard compactive effort) within the areas of fill placement.

A site inspection was conducted prior to any fill being placed on the Lot. On the completion of the earthworks and after examining the test results and the materials used, we are of the opinion that the filling procedure conducted by Winslow Constructors Pty Ltd satisfied the requirements of the Level 1 criteria specified in AS 3798 in regard to the placement of fill on a Type 1/2 Project.

Accordingly, when classifying the site in accordance with the procedures presented in Section 2 of AS 2870 – Residential slabs and footings (2011), we are of the view that the bulk fill materials that were placed over this Lot by Winslow Constructors Pty Ltd can be considered as having been placed in a controlled manner to a minimum density ratio of 95% (standard compactive effort). As such, the bulk fill materials would be deemed to be controlled fill that complies with Clause 1.8.13 of AS 2870. Hence, re-classification of the site to account for the fill presence is permitted under Clause 2.5.3 (c) of AS 2870.

## LIMITATIONS

The use of this Certificate is only appropriate for the field conditions present up to 21 November 2018.

A handwritten signature in blue ink, appearing to read 'Nick Brock', is written over a light blue circular stamp.

Nick Brock



---

## FILL CERTIFICATE

PROJECT: Lot No 421 (as per Drawing No 12332-4-E-107)  
Emerald Park Estate (Stage 4), Tarneit

CLIENT: Winslow Constructors Pty Ltd  
50 Barry Road  
CAMPBELLFIELD VIC 3061

REPORT NO: 18416\_421

DATE: 16 July 2019

---

## SUMMARY

Civil Geotechnical Services were engaged by Winslow Constructors Pty Ltd to provide inspection and testing services on the earthworks associated with the construction of Lot 421 of the Emerald Park Estate (Stage 4), Tarneit in a manner which would satisfy the criteria for Level 1 testing and inspection services as specified in Section 8.2 of AS 3798 - Guidelines on earthworks for commercial and residential developments (2007). The project was classified as Type 1/2 requiring a minimum density ratio of 95.0% (standard compactive effort) within the areas of fill placement.

A site inspection was conducted prior to any fill being placed on the Lot. On the completion of the earthworks and after examining the test results and the materials used, we are of the opinion that the filling procedure conducted by Winslow Constructors Pty Ltd satisfied the requirements of the Level 1 criteria specified in AS 3798 in regard to the placement of fill on a Type 1/2 Project.

Accordingly, when classifying the site in accordance with the procedures presented in Section 2 of AS 2870 – Residential slabs and footings (2011), we are of the view that the bulk fill materials that were placed over this Lot by Winslow Constructors Pty Ltd can be considered as having been placed in a controlled manner to a minimum density ratio of 95% (standard compactive effort). As such, the bulk fill materials would be deemed to be controlled fill that complies with Clause 1.8.13 of AS 2870. Hence, re-classification of the site to account for the fill presence is permitted under Clause 2.5.3 (c) of AS 2870.

## LIMITATIONS

The use of this Certificate is only appropriate for the field conditions present up to 21 November 2018.

A handwritten signature in blue ink, appearing to read 'Nick Brock', is written over a light blue circular stamp.

Nick Brock



---

## FILL CERTIFICATE

PROJECT: Lot No 422 (as per Drawing No 12332-4-E-107)  
Emerald Park Estate (Stage 4), Tarneit

CLIENT: Winslow Constructors Pty Ltd  
50 Barry Road  
CAMPBELLFIELD VIC 3061

REPORT NO: 18416\_422

DATE: 16 July 2019

---

## SUMMARY

Civil Geotechnical Services were engaged by Winslow Constructors Pty Ltd to provide inspection and testing services on the earthworks associated with the construction of Lot 422 of the Emerald Park Estate (Stage 4), Tarneit in a manner which would satisfy the criteria for Level 1 testing and inspection services as specified in Section 8.2 of AS 3798 - Guidelines on earthworks for commercial and residential developments (2007). The project was classified as Type 1/2 requiring a minimum density ratio of 95.0% (standard compactive effort) within the areas of fill placement.

A site inspection was conducted prior to any fill being placed on the Lot. On the completion of the earthworks and after examining the test results and the materials used, we are of the opinion that the filling procedure conducted by Winslow Constructors Pty Ltd satisfied the requirements of the Level 1 criteria specified in AS 3798 in regard to the placement of fill on a Type 1/2 Project.

Accordingly, when classifying the site in accordance with the procedures presented in Section 2 of AS 2870 – Residential slabs and footings (2011), we are of the view that the bulk fill materials that were placed over this Lot by Winslow Constructors Pty Ltd can be considered as having been placed in a controlled manner to a minimum density ratio of 95% (standard compactive effort). As such, the bulk fill materials would be deemed to be controlled fill that complies with Clause 1.8.13 of AS 2870. Hence, re-classification of the site to account for the fill presence is permitted under Clause 2.5.3 (c) of AS 2870.

## LIMITATIONS

The use of this Certificate is only appropriate for the field conditions present up to 21 November 2018.

A handwritten signature in blue ink, appearing to read 'Nick Brock', is written over a light blue circular stamp.

Nick Brock



---

## FILL CERTIFICATE

PROJECT: Lot No 423 (as per Drawing No 12332-4-E-107)  
Emerald Park Estate (Stage 4), Tarneit

CLIENT: Winslow Constructors Pty Ltd  
50 Barry Road  
CAMPBELLFIELD VIC 3061

REPORT NO: 18416\_423

DATE: 16 July 2019

---

## SUMMARY

Civil Geotechnical Services were engaged by Winslow Constructors Pty Ltd to provide inspection and testing services on the earthworks associated with the construction of Lot 423 of the Emerald Park Estate (Stage 4), Tarneit in a manner which would satisfy the criteria for Level 1 testing and inspection services as specified in Section 8.2 of AS 3798 - Guidelines on earthworks for commercial and residential developments (2007). The project was classified as Type 1/2 requiring a minimum density ratio of 95.0% (standard compactive effort) within the areas of fill placement.

A site inspection was conducted prior to any fill being placed on the Lot. On the completion of the earthworks and after examining the test results and the materials used, we are of the opinion that the filling procedure conducted by Winslow Constructors Pty Ltd satisfied the requirements of the Level 1 criteria specified in AS 3798 in regard to the placement of fill on a Type 1/2 Project.

Accordingly, when classifying the site in accordance with the procedures presented in Section 2 of AS 2870 – Residential slabs and footings (2011), we are of the view that the bulk fill materials that were placed over this Lot by Winslow Constructors Pty Ltd can be considered as having been placed in a controlled manner to a minimum density ratio of 95% (standard compactive effort). As such, the bulk fill materials would be deemed to be controlled fill that complies with Clause 1.8.13 of AS 2870. Hence, re-classification of the site to account for the fill presence is permitted under Clause 2.5.3 (c) of AS 2870.

## LIMITATIONS

The use of this Certificate is only appropriate for the field conditions present up to 21 November 2018.

A handwritten signature in blue ink, appearing to read 'Nick Brock', is written over a light blue circular stamp.

Nick Brock





---

## FILL CERTIFICATE

PROJECT: Lot No 424 (as per Drawing No 12332-4-E-107)  
Emerald Park Estate (Stage 4), Tarneit

CLIENT: Winslow Constructors Pty Ltd  
50 Barry Road  
CAMPBELLFIELD VIC 3061

REPORT NO: 18416\_424

DATE: 16 July 2019

---

## SUMMARY

Civil Geotechnical Services were engaged by Winslow Constructors Pty Ltd to provide inspection and testing services on the earthworks associated with the construction of Lot 424 of the Emerald Park Estate (Stage 4), Tarneit in a manner which would satisfy the criteria for Level 1 testing and inspection services as specified in Section 8.2 of AS 3798 - Guidelines on earthworks for commercial and residential developments (2007). The project was classified as Type 1/2 requiring a minimum density ratio of 95.0% (standard compactive effort) within the areas of fill placement.

A site inspection was conducted prior to any fill being placed on the Lot. On the completion of the earthworks and after examining the test results and the materials used, we are of the opinion that the filling procedure conducted by Winslow Constructors Pty Ltd satisfied the requirements of the Level 1 criteria specified in AS 3798 in regard to the placement of fill on a Type 1/2 Project.

Accordingly, when classifying the site in accordance with the procedures presented in Section 2 of AS 2870 – Residential slabs and footings (2011), we are of the view that the bulk fill materials that were placed over this Lot by Winslow Constructors Pty Ltd can be considered as having been placed in a controlled manner to a minimum density ratio of 95% (standard compactive effort). As such, the bulk fill materials would be deemed to be controlled fill that complies with Clause 1.8.13 of AS 2870. Hence, re-classification of the site to account for the fill presence is permitted under Clause 2.5.3 (c) of AS 2870.

## LIMITATIONS

The use of this Certificate is only appropriate for the field conditions present up to 21 November 2018.

A handwritten signature in blue ink, appearing to be 'Nick Brock', is written over a light blue circular stamp.

Nick Brock



---

## FILL CERTIFICATE

PROJECT: Lot No 425 (as per Drawing No 12332-4-E-107)  
Emerald Park Estate (Stage 4), Tarneit

CLIENT: Winslow Constructors Pty Ltd  
50 Barry Road  
CAMPBELLFIELD VIC 3061

REPORT NO: 18416\_425

DATE: 16 July 2019

---

## SUMMARY

Civil Geotechnical Services were engaged by Winslow Constructors Pty Ltd to provide inspection and testing services on the earthworks associated with the construction of Lot 425 of the Emerald Park Estate (Stage 4), Tarneit in a manner which would satisfy the criteria for Level 1 testing and inspection services as specified in Section 8.2 of AS 3798 - Guidelines on earthworks for commercial and residential developments (2007). The project was classified as Type 1/2 requiring a minimum density ratio of 95.0% (standard compactive effort) within the areas of fill placement.

A site inspection was conducted prior to any fill being placed on the Lot. On the completion of the earthworks and after examining the test results and the materials used, we are of the opinion that the filling procedure conducted by Winslow Constructors Pty Ltd satisfied the requirements of the Level 1 criteria specified in AS 3798 in regard to the placement of fill on a Type 1/2 Project.

Accordingly, when classifying the site in accordance with the procedures presented in Section 2 of AS 2870 – Residential slabs and footings (2011), we are of the view that the bulk fill materials that were placed over this Lot by Winslow Constructors Pty Ltd can be considered as having been placed in a controlled manner to a minimum density ratio of 95% (standard compactive effort). As such, the bulk fill materials would be deemed to be controlled fill that complies with Clause 1.8.13 of AS 2870. Hence, re-classification of the site to account for the fill presence is permitted under Clause 2.5.3 (c) of AS 2870.

## LIMITATIONS

The use of this Certificate is only appropriate for the field conditions present up to 21 November 2018.

A handwritten signature in blue ink, appearing to read 'Nick Brock', is written over a light blue circular stamp.

Nick Brock



---

## FILL CERTIFICATE

PROJECT: Lot No 427 (as per Drawing No 12332-4-E-107)  
Emerald Park Estate (Stage 4), Tarneit

CLIENT: Winslow Constructors Pty Ltd  
50 Barry Road  
CAMPBELLFIELD VIC 3061

REPORT NO: 18416\_427

DATE: 16 July 2019

---

## SUMMARY

Civil Geotechnical Services were engaged by Winslow Constructors Pty Ltd to provide inspection and testing services on the earthworks associated with the construction of Lot 427 of the Emerald Park Estate (Stage 4), Tarneit in a manner which would satisfy the criteria for Level 1 testing and inspection services as specified in Section 8.2 of AS 3798 - Guidelines on earthworks for commercial and residential developments (2007). The project was classified as Type 1/2 requiring a minimum density ratio of 95.0% (standard compactive effort) within the areas of fill placement.

A site inspection was conducted prior to any fill being placed on the Lot. On the completion of the earthworks and after examining the test results and the materials used, we are of the opinion that the filling procedure conducted by Winslow Constructors Pty Ltd satisfied the requirements of the Level 1 criteria specified in AS 3798 in regard to the placement of fill on a Type 1/2 Project.

Accordingly, when classifying the site in accordance with the procedures presented in Section 2 of AS 2870 – Residential slabs and footings (2011), we are of the view that the bulk fill materials that were placed over this Lot by Winslow Constructors Pty Ltd can be considered as having been placed in a controlled manner to a minimum density ratio of 95% (standard compactive effort). As such, the bulk fill materials would be deemed to be controlled fill that complies with Clause 1.8.13 of AS 2870. Hence, re-classification of the site to account for the fill presence is permitted under Clause 2.5.3 (c) of AS 2870.

## LIMITATIONS

The use of this Certificate is only appropriate for the field conditions present up to 21 November 2018.

A handwritten signature in blue ink, appearing to read 'Nick Brock', is written over a light blue circular stamp.

Nick Brock



---

## FILL CERTIFICATE

PROJECT: Lot No 428 (as per Drawing No 12332-4-E-107)  
Emerald Park Estate (Stage 4), Tarneit

CLIENT: Winslow Constructors Pty Ltd  
50 Barry Road  
CAMPBELLFIELD VIC 3061

REPORT NO: 18416\_428

DATE: 16 July 2019

---

## SUMMARY

Civil Geotechnical Services were engaged by Winslow Constructors Pty Ltd to provide inspection and testing services on the earthworks associated with the construction of Lot 428 of the Emerald Park Estate (Stage 4), Tarneit in a manner which would satisfy the criteria for Level 1 testing and inspection services as specified in Section 8.2 of AS 3798 - Guidelines on earthworks for commercial and residential developments (2007). The project was classified as Type 1/2 requiring a minimum density ratio of 95.0% (standard compactive effort) within the areas of fill placement.

A site inspection was conducted prior to any fill being placed on the Lot. On the completion of the earthworks and after examining the test results and the materials used, we are of the opinion that the filling procedure conducted by Winslow Constructors Pty Ltd satisfied the requirements of the Level 1 criteria specified in AS 3798 in regard to the placement of fill on a Type 1/2 Project.

Accordingly, when classifying the site in accordance with the procedures presented in Section 2 of AS 2870 – Residential slabs and footings (2011), we are of the view that the bulk fill materials that were placed over this Lot by Winslow Constructors Pty Ltd can be considered as having been placed in a controlled manner to a minimum density ratio of 95% (standard compactive effort). As such, the bulk fill materials would be deemed to be controlled fill that complies with Clause 1.8.13 of AS 2870. Hence, re-classification of the site to account for the fill presence is permitted under Clause 2.5.3 (c) of AS 2870.

## LIMITATIONS

The use of this Certificate is only appropriate for the field conditions present up to 21 November 2018.

A handwritten signature in blue ink, appearing to read 'Nick Brock', is written over a light blue circular stamp.

Nick Brock



---

## FILL CERTIFICATE

PROJECT: Lot No 429 (as per Drawing No 12332-4-E-107)  
Emerald Park Estate (Stage 4), Tarneit

CLIENT: Winslow Constructors Pty Ltd  
50 Barry Road  
CAMPBELLFIELD VIC 3061

REPORT NO: 18416\_429

DATE: 16 July 2019

---

## SUMMARY

Civil Geotechnical Services were engaged by Winslow Constructors Pty Ltd to provide inspection and testing services on the earthworks associated with the construction of Lot 429 of the Emerald Park Estate (Stage 4), Tarneit in a manner which would satisfy the criteria for Level 1 testing and inspection services as specified in Section 8.2 of AS 3798 - Guidelines on earthworks for commercial and residential developments (2007). The project was classified as Type 1/2 requiring a minimum density ratio of 95.0% (standard compactive effort) within the areas of fill placement.

A site inspection was conducted prior to any fill being placed on the Lot. On the completion of the earthworks and after examining the test results and the materials used, we are of the opinion that the filling procedure conducted by Winslow Constructors Pty Ltd satisfied the requirements of the Level 1 criteria specified in AS 3798 in regard to the placement of fill on a Type 1/2 Project.

Accordingly, when classifying the site in accordance with the procedures presented in Section 2 of AS 2870 – Residential slabs and footings (2011), we are of the view that the bulk fill materials that were placed over this Lot by Winslow Constructors Pty Ltd can be considered as having been placed in a controlled manner to a minimum density ratio of 95% (standard compactive effort). As such, the bulk fill materials would be deemed to be controlled fill that complies with Clause 1.8.13 of AS 2870. Hence, re-classification of the site to account for the fill presence is permitted under Clause 2.5.3 (c) of AS 2870.

## LIMITATIONS

The use of this Certificate is only appropriate for the field conditions present up to 21 November 2018.

A handwritten signature in blue ink, appearing to be 'Nick Brock', is written over a light blue circular stamp.

Nick Brock



---

## FILL CERTIFICATE

PROJECT: Lot No 430 (as per Drawing No 12332-4-E-107)  
Emerald Park Estate (Stage 4), Tarneit

CLIENT: Winslow Constructors Pty Ltd  
50 Barry Road  
CAMPBELLFIELD VIC 3061

REPORT NO: 18416\_430

DATE: 16 July 2019

---

## SUMMARY

Civil Geotechnical Services were engaged by Winslow Constructors Pty Ltd to provide inspection and testing services on the earthworks associated with the construction of Lot 430 of the Emerald Park Estate (Stage 4), Tarneit in a manner which would satisfy the criteria for Level 1 testing and inspection services as specified in Section 8.2 of AS 3798 - Guidelines on earthworks for commercial and residential developments (2007). The project was classified as Type 1/2 requiring a minimum density ratio of 95.0% (standard compactive effort) within the areas of fill placement.

A site inspection was conducted prior to any fill being placed on the Lot. On the completion of the earthworks and after examining the test results and the materials used, we are of the opinion that the filling procedure conducted by Winslow Constructors Pty Ltd satisfied the requirements of the Level 1 criteria specified in AS 3798 in regard to the placement of fill on a Type 1/2 Project.

Accordingly, when classifying the site in accordance with the procedures presented in Section 2 of AS 2870 – Residential slabs and footings (2011), we are of the view that the bulk fill materials that were placed over this Lot by Winslow Constructors Pty Ltd can be considered as having been placed in a controlled manner to a minimum density ratio of 95% (standard compactive effort). As such, the bulk fill materials would be deemed to be controlled fill that complies with Clause 1.8.13 of AS 2870. Hence, re-classification of the site to account for the fill presence is permitted under Clause 2.5.3 (c) of AS 2870.

## LIMITATIONS

The use of this Certificate is only appropriate for the field conditions present up to 21 November 2018.

A handwritten signature in blue ink, appearing to be 'Nick Brock', is written over a light blue circular stamp.

Nick Brock



## FILL CERTIFICATE

PROJECT: Lot No 431 (as per Drawing No 12332-4-E-107)  
Emerald Park Estate (Stage 4), Tarneit

CLIENT: Winslow Constructors Pty Ltd  
50 Barry Road  
CAMPBELLFIELD VIC 3061

REPORT NO: 18416\_431

DATE: 16 July 2019

---

## SUMMARY

Civil Geotechnical Services were engaged by Winslow Constructors Pty Ltd to provide inspection and testing services on the earthworks associated with the construction of Lot 431 of the Emerald Park Estate (Stage 4), Tarneit in a manner which would satisfy the criteria for Level 1 testing and inspection services as specified in Section 8.2 of AS 3798 - Guidelines on earthworks for commercial and residential developments (2007). The project was classified as Type 1/2 requiring a minimum density ratio of 95.0% (standard compactive effort) within the areas of fill placement.

A site inspection was conducted prior to any fill being placed on the Lot. On the completion of the earthworks and after examining the test results and the materials used, we are of the opinion that the filling procedure conducted by Winslow Constructors Pty Ltd satisfied the requirements of the Level 1 criteria specified in AS 3798 in regard to the placement of fill on a Type 1/2 Project.

Accordingly, when classifying the site in accordance with the procedures presented in Section 2 of AS 2870 – Residential slabs and footings (2011), we are of the view that the bulk fill materials that were placed over this Lot by Winslow Constructors Pty Ltd can be considered as having been placed in a controlled manner to a minimum density ratio of 95% (standard compactive effort). As such, the bulk fill materials would be deemed to be controlled fill that complies with Clause 1.8.13 of AS 2870. Hence, re-classification of the site to account for the fill presence is permitted under Clause 2.5.3 (c) of AS 2870.

## LIMITATIONS

The use of this Certificate is only appropriate for the field conditions present up to 21 November 2018.

A handwritten signature in blue ink, appearing to read 'Nick Brock', is written over a light blue circular stamp.

Nick Brock



---

## FILL CERTIFICATE

PROJECT: Lot No 432 (as per Drawing No 12332-4-E-107)  
Emerald Park Estate (Stage 4), Tarneit

CLIENT: Winslow Constructors Pty Ltd  
50 Barry Road  
CAMPBELLFIELD VIC 3061

REPORT NO: 18416\_432

DATE: 16 July 2019

---

## SUMMARY

Civil Geotechnical Services were engaged by Winslow Constructors Pty Ltd to provide inspection and testing services on the earthworks associated with the construction of Lot 432 of the Emerald Park Estate (Stage 4), Tarneit in a manner which would satisfy the criteria for Level 1 testing and inspection services as specified in Section 8.2 of AS 3798 - Guidelines on earthworks for commercial and residential developments (2007). The project was classified as Type 1/2 requiring a minimum density ratio of 95.0% (standard compactive effort) within the areas of fill placement.

A site inspection was conducted prior to any fill being placed on the Lot. On the completion of the earthworks and after examining the test results and the materials used, we are of the opinion that the filling procedure conducted by Winslow Constructors Pty Ltd satisfied the requirements of the Level 1 criteria specified in AS 3798 in regard to the placement of fill on a Type 1/2 Project.

Accordingly, when classifying the site in accordance with the procedures presented in Section 2 of AS 2870 – Residential slabs and footings (2011), we are of the view that the bulk fill materials that were placed over this Lot by Winslow Constructors Pty Ltd can be considered as having been placed in a controlled manner to a minimum density ratio of 95% (standard compactive effort). As such, the bulk fill materials would be deemed to be controlled fill that complies with Clause 1.8.13 of AS 2870. Hence, re-classification of the site to account for the fill presence is permitted under Clause 2.5.3 (c) of AS 2870.

## LIMITATIONS

The use of this Certificate is only appropriate for the field conditions present up to 21 November 2018.

A handwritten signature in blue ink, appearing to read 'Nick Brock', is written over a light blue circular stamp.

Nick Brock





---

## FILL CERTIFICATE

PROJECT: Lot No 433 (as per Drawing No 12332-4-E-107)  
Emerald Park Estate (Stage 4), Tarneit

CLIENT: Winslow Constructors Pty Ltd  
50 Barry Road  
CAMPBELLFIELD VIC 3061

REPORT NO: 18416\_433

DATE: 16 July 2019

---

## SUMMARY

Civil Geotechnical Services were engaged by Winslow Constructors Pty Ltd to provide inspection and testing services on the earthworks associated with the construction of Lot 433 of the Emerald Park Estate (Stage 4), Tarneit in a manner which would satisfy the criteria for Level 1 testing and inspection services as specified in Section 8.2 of AS 3798 - Guidelines on earthworks for commercial and residential developments (2007). The project was classified as Type 1/2 requiring a minimum density ratio of 95.0% (standard compactive effort) within the areas of fill placement.

A site inspection was conducted prior to any fill being placed on the Lot. On the completion of the earthworks and after examining the test results and the materials used, we are of the opinion that the filling procedure conducted by Winslow Constructors Pty Ltd satisfied the requirements of the Level 1 criteria specified in AS 3798 in regard to the placement of fill on a Type 1/2 Project.

Accordingly, when classifying the site in accordance with the procedures presented in Section 2 of AS 2870 – Residential slabs and footings (2011), we are of the view that the bulk fill materials that were placed over this Lot by Winslow Constructors Pty Ltd can be considered as having been placed in a controlled manner to a minimum density ratio of 95% (standard compactive effort). As such, the bulk fill materials would be deemed to be controlled fill that complies with Clause 1.8.13 of AS 2870. Hence, re-classification of the site to account for the fill presence is permitted under Clause 2.5.3 (c) of AS 2870.

## LIMITATIONS

The use of this Certificate is only appropriate for the field conditions present up to 21 November 2018.

A handwritten signature in blue ink, appearing to be 'Nick Brock', is written over a light blue circular stamp.

Nick Brock



---

## FILL CERTIFICATE

PROJECT: Lot No 434 (as per Drawing No 12332-4-E-107)  
Emerald Park Estate (Stage 4), Tarneit

CLIENT: Winslow Constructors Pty Ltd  
50 Barry Road  
CAMPBELLFIELD VIC 3061

REPORT NO: 18416\_434

DATE: 16 July 2019

---

## SUMMARY

Civil Geotechnical Services were engaged by Winslow Constructors Pty Ltd to provide inspection and testing services on the earthworks associated with the construction of Lot 434 of the Emerald Park Estate (Stage 4), Tarneit in a manner which would satisfy the criteria for Level 1 testing and inspection services as specified in Section 8.2 of AS 3798 - Guidelines on earthworks for commercial and residential developments (2007). The project was classified as Type 1/2 requiring a minimum density ratio of 95.0% (standard compactive effort) within the areas of fill placement.

A site inspection was conducted prior to any fill being placed on the Lot. On the completion of the earthworks and after examining the test results and the materials used, we are of the opinion that the filling procedure conducted by Winslow Constructors Pty Ltd satisfied the requirements of the Level 1 criteria specified in AS 3798 in regard to the placement of fill on a Type 1/2 Project.

Accordingly, when classifying the site in accordance with the procedures presented in Section 2 of AS 2870 – Residential slabs and footings (2011), we are of the view that the bulk fill materials that were placed over this Lot by Winslow Constructors Pty Ltd can be considered as having been placed in a controlled manner to a minimum density ratio of 95% (standard compactive effort). As such, the bulk fill materials would be deemed to be controlled fill that complies with Clause 1.8.13 of AS 2870. Hence, re-classification of the site to account for the fill presence is permitted under Clause 2.5.3 (c) of AS 2870.

## LIMITATIONS

The use of this Certificate is only appropriate for the field conditions present up to 21 November 2018.

A handwritten signature in blue ink, appearing to read 'Nick Brock', is written over a light blue circular stamp.

Nick Brock



---

## FILL CERTIFICATE

PROJECT: Lot No 435 (as per Drawing No 12332-4-E-107)  
Emerald Park Estate (Stage 4), Tarneit

CLIENT: Winslow Constructors Pty Ltd  
50 Barry Road  
CAMPBELLFIELD VIC 3061

REPORT NO: 18416\_435

DATE: 16 July 2019

---

## SUMMARY

Civil Geotechnical Services were engaged by Winslow Constructors Pty Ltd to provide inspection and testing services on the earthworks associated with the construction of Lot 435 of the Emerald Park Estate (Stage 4), Tarneit in a manner which would satisfy the criteria for Level 1 testing and inspection services as specified in Section 8.2 of AS 3798 - Guidelines on earthworks for commercial and residential developments (2007). The project was classified as Type 1/2 requiring a minimum density ratio of 95.0% (standard compactive effort) within the areas of fill placement.

A site inspection was conducted prior to any fill being placed on the Lot. On the completion of the earthworks and after examining the test results and the materials used, we are of the opinion that the filling procedure conducted by Winslow Constructors Pty Ltd satisfied the requirements of the Level 1 criteria specified in AS 3798 in regard to the placement of fill on a Type 1/2 Project.

Accordingly, when classifying the site in accordance with the procedures presented in Section 2 of AS 2870 – Residential slabs and footings (2011), we are of the view that the bulk fill materials that were placed over this Lot by Winslow Constructors Pty Ltd can be considered as having been placed in a controlled manner to a minimum density ratio of 95% (standard compactive effort). As such, the bulk fill materials would be deemed to be controlled fill that complies with Clause 1.8.13 of AS 2870. Hence, re-classification of the site to account for the fill presence is permitted under Clause 2.5.3 (c) of AS 2870.

## LIMITATIONS

The use of this Certificate is only appropriate for the field conditions present up to 21 November 2018.

A handwritten signature in blue ink, appearing to be 'Nick Brock', is written over a light blue circular stamp.

Nick Brock



---

## FILL CERTIFICATE

PROJECT: Lot No 436 (as per Drawing No 12332-4-E-107)  
Emerald Park Estate (Stage 4), Tarneit

CLIENT: Winslow Constructors Pty Ltd  
50 Barry Road  
CAMPBELLFIELD VIC 3061

REPORT NO: 18416\_436

DATE: 16 July 2019

---

## SUMMARY

Civil Geotechnical Services were engaged by Winslow Constructors Pty Ltd to provide inspection and testing services on the earthworks associated with the construction of Lot 436 of the Emerald Park Estate (Stage 4), Tarneit in a manner which would satisfy the criteria for Level 1 testing and inspection services as specified in Section 8.2 of AS 3798 - Guidelines on earthworks for commercial and residential developments (2007). The project was classified as Type 1/2 requiring a minimum density ratio of 95.0% (standard compactive effort) within the areas of fill placement.

A site inspection was conducted prior to any fill being placed on the Lot. On the completion of the earthworks and after examining the test results and the materials used, we are of the opinion that the filling procedure conducted by Winslow Constructors Pty Ltd satisfied the requirements of the Level 1 criteria specified in AS 3798 in regard to the placement of fill on a Type 1/2 Project.

Accordingly, when classifying the site in accordance with the procedures presented in Section 2 of AS 2870 – Residential slabs and footings (2011), we are of the view that the bulk fill materials that were placed over this Lot by Winslow Constructors Pty Ltd can be considered as having been placed in a controlled manner to a minimum density ratio of 95% (standard compactive effort). As such, the bulk fill materials would be deemed to be controlled fill that complies with Clause 1.8.13 of AS 2870. Hence, re-classification of the site to account for the fill presence is permitted under Clause 2.5.3 (c) of AS 2870.

## LIMITATIONS

The use of this Certificate is only appropriate for the field conditions present up to 21 November 2018.

A handwritten signature in blue ink, appearing to be 'Nick Brock', is written over a light blue circular stamp.

Nick Brock



---

## FILL CERTIFICATE

PROJECT: Lot No 438 (as per Drawing No 12332-4-E-107)  
Emerald Park Estate (Stage 4), Tarneit

CLIENT: Winslow Constructors Pty Ltd  
50 Barry Road  
CAMPBELLFIELD VIC 3061

REPORT NO: 18416\_438

DATE: 16 July 2019

---

## SUMMARY

Civil Geotechnical Services were engaged by Winslow Constructors Pty Ltd to provide inspection and testing services on the earthworks associated with the construction of Lot 438 of the Emerald Park Estate (Stage 4), Tarneit in a manner which would satisfy the criteria for Level 1 testing and inspection services as specified in Section 8.2 of AS 3798 - Guidelines on earthworks for commercial and residential developments (2007). The project was classified as Type 1/2 requiring a minimum density ratio of 95.0% (standard compactive effort) within the areas of fill placement.

A site inspection was conducted prior to any fill being placed on the Lot. On the completion of the earthworks and after examining the test results and the materials used, we are of the opinion that the filling procedure conducted by Winslow Constructors Pty Ltd satisfied the requirements of the Level 1 criteria specified in AS 3798 in regard to the placement of fill on a Type 1/2 Project.

Accordingly, when classifying the site in accordance with the procedures presented in Section 2 of AS 2870 – Residential slabs and footings (2011), we are of the view that the bulk fill materials that were placed over this Lot by Winslow Constructors Pty Ltd can be considered as having been placed in a controlled manner to a minimum density ratio of 95% (standard compactive effort). As such, the bulk fill materials would be deemed to be controlled fill that complies with Clause 1.8.13 of AS 2870. Hence, re-classification of the site to account for the fill presence is permitted under Clause 2.5.3 (c) of AS 2870.

## LIMITATIONS

The use of this Certificate is only appropriate for the field conditions present up to 21 November 2018.

A handwritten signature in blue ink, appearing to be 'Nick Brock', is written over a light blue circular stamp.

Nick Brock



**CIVIL GEOTECHNICAL SERVICES**  
**ABN 26 474 013 724**  
**PO Box 678 Croydon Vic 3136**  
**Telephone: 9723 0744 Facsimile: 9723 0799**

16<sup>th</sup> July 2019

Our Reference: 18416:NB527

Winslow Constructors Pty Ltd  
50 Barry Road  
CAMPBELLFIELD VIC 3061

Dear Sirs/Madams,

**RE: LEVEL 1 EARTHWORKS INSPECTION AND TESTING**  
**EMERALD PARK – STAGE 4 (TARNEIT)**

Please find attached our Report No's 18416/R001 to 18416/R003 which relate to the field density testing that was conducted within the filled allotments at the above subdivision. The level 1 inspections and associated field density testing commenced in July 2018 and was completed in November 2018.

The inspections and testing of the earthworks was undertaken in general accordance with the Level 1 requirements of AS 3798 - Guidelines on Earthworks for Commercial and Residential Developments.

The site inspection and testing was performed by experienced geotechnicians from this office. Any areas that were deemed unsatisfactory were reworked and retested under their supervision. The testing was performed to the relevant Australian Standards and the accompanying test reports carry NATA endorsement. The attached compaction results, which were located randomly throughout the fill profile, are considered to be representative of the bulk fill materials that were placed across the reported allotments by Winslow Constructors during the aforementioned period. The approximate locations of the field density tests can be seen on the attached plan (Figure 1).

We are of the view that the bulk fill materials that have been placed across the reported allotments by Winslow Constructors during the aforementioned period can be considered as having been placed in a controlled manner to a minimum density ratio of 95% (standard compactive effort).

Please contact the undersigned if you require any additional information.

Civil Geotechnical Services

A handwritten signature in blue ink, appearing to read 'Nick Brock', is written over a faint circular stamp.

Nick Brock



# FIGURE 1

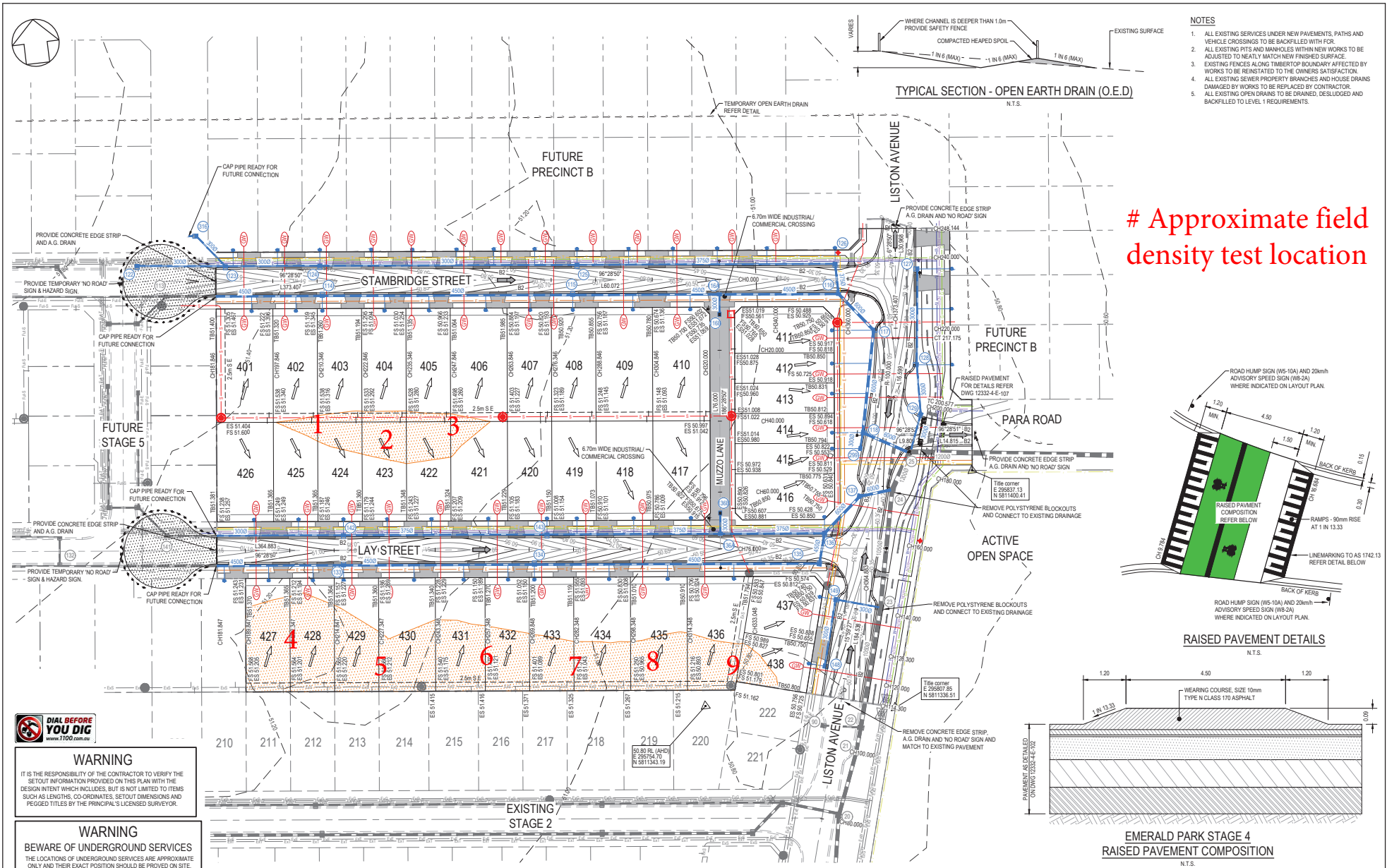

- NOTES**
1. ALL EXISTING SERVICES UNDER NEW PAVEMENTS, PATHS AND VEHICLE CROSSINGS TO BE BACKFILLED WITH FC-1.
  2. ALL EXISTING PITS AND MANHOLES WITHIN NEW WORKS TO BE ADJUSTED TO NEATLY MATCH NEW FINISHED SURFACE.
  3. EXISTING FENCES ALONG TIMBERTOP BOUNDARY AFFECTED BY WORKS TO BE REINSTATED TO THE OWNERS SATISFACTION.
  4. ALL EXISTING SEWER PROPERTY BRANCHES AND HOUSE DRAINS DAMAGED BY WORKS TO BE REPLACED BY CONTRACTOR.
  5. ALL EXISTING OPEN DRAINS TO BE DRAINED, DESLUDGED AND BACKFILLED TO LEVEL 1 REQUIREMENTS.

# Approximate field density test location



**WARNING**  
IT IS THE RESPONSIBILITY OF THE CONTRACTOR TO VERIFY THE SETOUT INFORMATION PROVIDED ON THIS PLAN WITH THE DESIGN INTENT WHICH INCLUDES, BUT IS NOT LIMITED TO ITEMS SUCH AS LENGTHS, CO-ORDINATES, SETOUT DIMENSIONS AND PEGGED TITLES BY THE PRINCIPAL'S LICENSED SURVEYOR.

**WARNING**  
**BEWARE OF UNDERGROUND SERVICES**  
THE LOCATIONS OF UNDERGROUND SERVICES ARE APPROXIMATE ONLY AND THEIR EXACT POSITION SHOULD BE PROVIDED ON SITE. NO GUARANTEE IS GIVEN THAT ALL EXISTING SERVICES ARE SHOWN. A MOCS ENQUIRY ON 1100 MUST BE MADE BY THE CONTRACTOR PRIOR TO COMMENCEMENT OF WORKS.

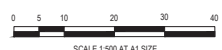

Existing Gas Main	Proposed Gas Main	Street Name Sign	T.B.M.
Existing Water Main	Proposed Water Main	Proposed Gas & Water Control	Existing surface level
Existing Electricity Cable	Proposed Electricity Cable	Existing surface level	ES 51.200
Existing Telecom Cable in Pit	Proposed Telecom Cable	Finished surface building line & road reserve	FS 51.040
Existing Sewer Main & M.H.	Proposed Sewer Main & M.H.	Finished surface top of batter	TB 51.200
Existing Drain & Pit	Proposed Drain & Pit	Filling on lots deeper than 200mm	
Existing Property Wall	Proposed Property Walls		
Open Drain			



**TAYLORS**  
Urban Development | Infrastructure  
#127 Fernvale Quay Road, Madding Hill, Victoria, 3168  
Tel: 61 3 9851 2861 | www.taylors.com.au

DESIGNED: TNO AUTHORIZED: JOY DRAFTED: 12332-4-E  
CHECKED: AHM AUTH. DATE: 43014 CAD REF: 12332-4-E-107

WYNDHAM CITY COUNCIL	SCALE 1:500 @ A1, 1:1000 @ A3
EMERALD PARK STAGE 4	VERSION 0
DETAIL LAYOUT PLAN	SHEET 8 OF 26
	DRAWING NO. 12332-4-E-107



## COMPACTION ASSESSMENT

Job No 18416  
 Report No 18416/R001  
 Date Issued 13/12/2018

**CIVIL GEOTECHNICAL SERVICES**

6 - 8 Rose Avenue, Croydon 3136

Client	WINSLOW CONSTRUCTORS PTY LTD (CAMPBELLFIELD)	Tested by	BS
Project	EMERALD PARK - STAGE 4	Date tested	19/11/18
Location	TARNEIT	Checked by	JHF

<b>Feature</b>	EARTHWORKS	Layer thickness	300 mm	Time: 12:51
----------------	------------	-----------------	--------	-------------

Test procedure AS 1289.2.1.1 & 5.8.1

Test No	1	2	3	-	-	-
Location	REFER TO FIGURE 1	REFER TO FIGURE 1	REFER TO FIGURE 1			
Approximate depth below FSL						
Measurement depth <i>mm</i>	175	175	175	-	-	-
Field wet density <i>t/m<sup>3</sup></i>	1.76	1.79	1.77	-	-	-
Field moisture content <i>%</i>	28.6	21.8	22.8	-	-	-

Test procedure AS 1289.5.7.1

Test No	1	2	3	-	-	-
Compactive effort	Standard					
Oversize rock retained on sieve <i>mm</i>	19.0	19.0	19.0	-	-	-
Percent of oversize material <i>wet</i>	0	0	0	-	-	-
Peak Converted Wet Density <i>t/m<sup>3</sup></i>	1.83	1.85	1.84	-	-	-
Adjusted Peak Converted Wet Density <i>t/m<sup>3</sup></i>	-	-	-	-	-	-
Optimum Moisture Content <i>%</i>	30.5	24.5	25.5	-	-	-

Moisture Variation From Optimum Moisture Content	2.0% dry	2.5% dry	2.5% dry	-	-	-
--	----------	----------	----------	---	---	---

<b>Density Ratio ( <math>R_{HD}</math> )</b>	<b>%</b>	<b>96.5</b>	<b>96.5</b>	<b>96.5</b>	-	-	-
--	----------	-------------	-------------	-------------	---	---	---

Material description

No 1 - 3 Clay Fill						
--------------------	--	--	--	--	--	--

AVRLOT HILF V1.10 MAR 13



The results of the tests, calibrations and/or measurements included in this document are traceable to Australian/National standards. Accredited for compliance to ISO/IEC 17025. Accreditation No 9909

Approved Signatory : Justin Fry





## COMPACTION ASSESSMENT

Job No 18416  
 Report No 18416/R002  
 Date Issued 14/12/2018

**CIVIL GEOTECHNICAL SERVICES**

6 - 8 Rose Avenue, Croydon 3136

Client	WINSLOW CONSTRUCTORS PTY LTD (CAMPBELLFIELD)	Tested by	BS
Project	EMERALD PARK - STAGE 4	Date tested	21/11/18
Location	TARNEIT	Checked by	JHF

<b>Feature</b>	EARTHWORKS	Layer thickness	200 mm	Time: 14:03
----------------	------------	-----------------	--------	-------------

Test procedure AS 1289.2.1.1 & 5.8.1

Test No	4	5	6	7	8	9
Location	REFER TO FIGURE 1	REFER TO FIGURE 1	REFER TO FIGURE 1	REFER TO FIGURE 1	REFER TO FIGURE 1	REFER TO FIGURE 1
Approximate depth below FSL						
Measurement depth <i>mm</i>	175	175	175	175	175	175
Field wet density <i>t/m<sup>3</sup></i>	1.91	1.85	1.79	1.87	1.86	1.83
Field moisture content <i>%</i>	23.2	24.3	23.5	24.8	26.0	24.7

Test procedure AS 1289.5.7.1

Test No	4	5	6	7	8	9
Compactive effort	Standard					
Oversize rock retained on sieve <i>mm</i>	19.0	19.0	19.0	19.0	19.0	19.0
Percent of oversize material <i>wet</i>	0	0	0	0	0	0
Peak Converted Wet Density <i>t/m<sup>3</sup></i>	1.95	1.90	1.88	1.89	1.90	1.90
Adjusted Peak Converted Wet Density <i>t/m<sup>3</sup></i>	-	-	-	-	-	-
Optimum Moisture Content <i>%</i>	25.5	27.0	26.0	27.5	28.5	27.5

Moisture Variation From Optimum Moisture Content	2.0% dry	2.5% dry	2.5% dry	2.5% dry	2.0% dry	2.5% dry
--	----------	----------	----------	----------	----------	----------

<b>Density Ratio ( <math>R_{HD}</math> )</b>	<b>%</b>	<b>98.0</b>	<b>97.5</b>	<b>95.5</b>	<b>99.0</b>	<b>98.0</b>	<b>97.0</b>
--	----------	-------------	-------------	-------------	-------------	-------------	-------------

Material description

No 4 - 9 Clay Fill
--------------------



The results of the tests, calibrations and/or measurements included in this document are traceable to Australian/National standards. Accredited for compliance to ISO/IEC 17025. Accreditation No 9909

Approved Signatory : Justin Fry