



FILL CERTIFICATE

PROJECT: Lot No 501 (as per Drawing No 12332-5-E-107)
Emerald Park Estate (Stage 5), Tarneit

CLIENT: Winslow Constructors Pty Ltd
50 Barry Road
CAMPBELLFIELD VIC 3061

REPORT NO: 18417_501

DATE: 16 July 2019

SUMMARY

Civil Geotechnical Services were engaged by Winslow Constructors Pty Ltd to provide inspection and testing services on the earthworks associated with the construction of Lot 501 of the Emerald Park Estate (Stage 5), Tarneit in a manner which would satisfy the criteria for Level 1 testing and inspection services as specified in Section 8.2 of AS 3798 - Guidelines on earthworks for commercial and residential developments (2007). The project was classified as Type 1/2 requiring a minimum density ratio of 95.0% (standard compactive effort) within the areas of fill placement.

A site inspection was conducted prior to any fill being placed on the Lot. On the completion of the earthworks and after examining the test results and the materials used, we are of the opinion that the filling procedure conducted by Winslow Constructors Pty Ltd satisfied the requirements of the Level 1 criteria specified in AS 3798 in regard to the placement of fill on a Type 1/2 Project.

Accordingly, when classifying the site in accordance with the procedures presented in Section 2 of AS 2870 – Residential slabs and footings (2011), we are of the view that the bulk fill materials that were placed over this Lot by Winslow Constructors Pty Ltd can be considered as having been placed in a controlled manner to a minimum density ratio of 95% (standard compactive effort). As such, the bulk fill materials would be deemed to be controlled fill that complies with Clause 1.8.13 of AS 2870. Hence, re-classification of the site to account for the fill presence is permitted under Clause 2.5.3 (c) of AS 2870.

LIMITATIONS

The use of this Certificate is only appropriate for the field conditions present up to 21 November 2018.

A handwritten signature in blue ink, appearing to be 'Nick Brock', is written over a light blue circular stamp.

Nick Brock



FILL CERTIFICATE

PROJECT: Lot No 502 (as per Drawing No 12332-5-E-107)
Emerald Park Estate (Stage 5), Tarneit

CLIENT: Winslow Constructors Pty Ltd
50 Barry Road
CAMPBELLFIELD VIC 3061

REPORT NO: 18417_502

DATE: 16 July 2019

SUMMARY

Civil Geotechnical Services were engaged by Winslow Constructors Pty Ltd to provide inspection and testing services on the earthworks associated with the construction of Lot 502 of the Emerald Park Estate (Stage 5), Tarneit in a manner which would satisfy the criteria for Level 1 testing and inspection services as specified in Section 8.2 of AS 3798 - Guidelines on earthworks for commercial and residential developments (2007). The project was classified as Type 1/2 requiring a minimum density ratio of 95.0% (standard compactive effort) within the areas of fill placement.

A site inspection was conducted prior to any fill being placed on the Lot. On the completion of the earthworks and after examining the test results and the materials used, we are of the opinion that the filling procedure conducted by Winslow Constructors Pty Ltd satisfied the requirements of the Level 1 criteria specified in AS 3798 in regard to the placement of fill on a Type 1/2 Project.

Accordingly, when classifying the site in accordance with the procedures presented in Section 2 of AS 2870 – Residential slabs and footings (2011), we are of the view that the bulk fill materials that were placed over this Lot by Winslow Constructors Pty Ltd can be considered as having been placed in a controlled manner to a minimum density ratio of 95% (standard compactive effort). As such, the bulk fill materials would be deemed to be controlled fill that complies with Clause 1.8.13 of AS 2870. Hence, re-classification of the site to account for the fill presence is permitted under Clause 2.5.3 (c) of AS 2870.

LIMITATIONS

The use of this Certificate is only appropriate for the field conditions present up to 21 November 2018.

A handwritten signature in blue ink, appearing to read 'Nick Brock', is written over a light blue circular stamp.

Nick Brock



FILL CERTIFICATE

PROJECT: Lot No 503 (as per Drawing No 12332-5-E-107)
Emerald Park Estate (Stage 5), Tarneit

CLIENT: Winslow Constructors Pty Ltd
50 Barry Road
CAMPBELLFIELD VIC 3061

REPORT NO: 18417_503

DATE: 16 July 2019

SUMMARY

Civil Geotechnical Services were engaged by Winslow Constructors Pty Ltd to provide inspection and testing services on the earthworks associated with the construction of Lot 503 of the Emerald Park Estate (Stage 5), Tarneit in a manner which would satisfy the criteria for Level 1 testing and inspection services as specified in Section 8.2 of AS 3798 - Guidelines on earthworks for commercial and residential developments (2007). The project was classified as Type 1/2 requiring a minimum density ratio of 95.0% (standard compactive effort) within the areas of fill placement.

A site inspection was conducted prior to any fill being placed on the Lot. On the completion of the earthworks and after examining the test results and the materials used, we are of the opinion that the filling procedure conducted by Winslow Constructors Pty Ltd satisfied the requirements of the Level 1 criteria specified in AS 3798 in regard to the placement of fill on a Type 1/2 Project.

Accordingly, when classifying the site in accordance with the procedures presented in Section 2 of AS 2870 – Residential slabs and footings (2011), we are of the view that the bulk fill materials that were placed over this Lot by Winslow Constructors Pty Ltd can be considered as having been placed in a controlled manner to a minimum density ratio of 95% (standard compactive effort). As such, the bulk fill materials would be deemed to be controlled fill that complies with Clause 1.8.13 of AS 2870. Hence, re-classification of the site to account for the fill presence is permitted under Clause 2.5.3 (c) of AS 2870.

LIMITATIONS

The use of this Certificate is only appropriate for the field conditions present up to 21 November 2018.

A handwritten signature in blue ink, appearing to be 'Nick Brock', is written over a light blue circular stamp.

Nick Brock



FILL CERTIFICATE

PROJECT: Lot No 504 (as per Drawing No 12332-5-E-107)
Emerald Park Estate (Stage 5), Tarneit

CLIENT: Winslow Constructors Pty Ltd
50 Barry Road
CAMPBELLFIELD VIC 3061

REPORT NO: 18417_504

DATE: 16 July 2019

SUMMARY

Civil Geotechnical Services were engaged by Winslow Constructors Pty Ltd to provide inspection and testing services on the earthworks associated with the construction of Lot 504 of the Emerald Park Estate (Stage 5), Tarneit in a manner which would satisfy the criteria for Level 1 testing and inspection services as specified in Section 8.2 of AS 3798 - Guidelines on earthworks for commercial and residential developments (2007). The project was classified as Type 1/2 requiring a minimum density ratio of 95.0% (standard compactive effort) within the areas of fill placement.

A site inspection was conducted prior to any fill being placed on the Lot. On the completion of the earthworks and after examining the test results and the materials used, we are of the opinion that the filling procedure conducted by Winslow Constructors Pty Ltd satisfied the requirements of the Level 1 criteria specified in AS 3798 in regard to the placement of fill on a Type 1/2 Project.

Accordingly, when classifying the site in accordance with the procedures presented in Section 2 of AS 2870 – Residential slabs and footings (2011), we are of the view that the bulk fill materials that were placed over this Lot by Winslow Constructors Pty Ltd can be considered as having been placed in a controlled manner to a minimum density ratio of 95% (standard compactive effort). As such, the bulk fill materials would be deemed to be controlled fill that complies with Clause 1.8.13 of AS 2870. Hence, re-classification of the site to account for the fill presence is permitted under Clause 2.5.3 (c) of AS 2870.

LIMITATIONS

The use of this Certificate is only appropriate for the field conditions present up to 21 November 2018.

A handwritten signature in blue ink, appearing to be 'Nick Brock', is written over a light blue circular stamp.

Nick Brock



FILL CERTIFICATE

PROJECT: Lot No 505 (as per Drawing No 12332-5-E-107)
Emerald Park Estate (Stage 5), Tarneit

CLIENT: Winslow Constructors Pty Ltd
50 Barry Road
CAMPBELLFIELD VIC 3061

REPORT NO: 18417_505

DATE: 16 July 2019

SUMMARY

Civil Geotechnical Services were engaged by Winslow Constructors Pty Ltd to provide inspection and testing services on the earthworks associated with the construction of Lot 505 of the Emerald Park Estate (Stage 5), Tarneit in a manner which would satisfy the criteria for Level 1 testing and inspection services as specified in Section 8.2 of AS 3798 - Guidelines on earthworks for commercial and residential developments (2007). The project was classified as Type 1/2 requiring a minimum density ratio of 95.0% (standard compactive effort) within the areas of fill placement.

A site inspection was conducted prior to any fill being placed on the Lot. On the completion of the earthworks and after examining the test results and the materials used, we are of the opinion that the filling procedure conducted by Winslow Constructors Pty Ltd satisfied the requirements of the Level 1 criteria specified in AS 3798 in regard to the placement of fill on a Type 1/2 Project.

Accordingly, when classifying the site in accordance with the procedures presented in Section 2 of AS 2870 – Residential slabs and footings (2011), we are of the view that the bulk fill materials that were placed over this Lot by Winslow Constructors Pty Ltd can be considered as having been placed in a controlled manner to a minimum density ratio of 95% (standard compactive effort). As such, the bulk fill materials would be deemed to be controlled fill that complies with Clause 1.8.13 of AS 2870. Hence, re-classification of the site to account for the fill presence is permitted under Clause 2.5.3 (c) of AS 2870.

LIMITATIONS

The use of this Certificate is only appropriate for the field conditions present up to 21 November 2018.

A handwritten signature in blue ink, appearing to read 'Nick Brock', is written over a light blue circular stamp.

Nick Brock



FILL CERTIFICATE

PROJECT: Lot No 506 (as per Drawing No 12332-5-E-107)
Emerald Park Estate (Stage 5), Tarneit

CLIENT: Winslow Constructors Pty Ltd
50 Barry Road
CAMPBELLFIELD VIC 3061

REPORT NO: 18417_506

DATE: 16 July 2019

SUMMARY

Civil Geotechnical Services were engaged by Winslow Constructors Pty Ltd to provide inspection and testing services on the earthworks associated with the construction of Lot 506 of the Emerald Park Estate (Stage 5), Tarneit in a manner which would satisfy the criteria for Level 1 testing and inspection services as specified in Section 8.2 of AS 3798 - Guidelines on earthworks for commercial and residential developments (2007). The project was classified as Type 1/2 requiring a minimum density ratio of 95.0% (standard compactive effort) within the areas of fill placement.

A site inspection was conducted prior to any fill being placed on the Lot. On the completion of the earthworks and after examining the test results and the materials used, we are of the opinion that the filling procedure conducted by Winslow Constructors Pty Ltd satisfied the requirements of the Level 1 criteria specified in AS 3798 in regard to the placement of fill on a Type 1/2 Project.

Accordingly, when classifying the site in accordance with the procedures presented in Section 2 of AS 2870 – Residential slabs and footings (2011), we are of the view that the bulk fill materials that were placed over this Lot by Winslow Constructors Pty Ltd can be considered as having been placed in a controlled manner to a minimum density ratio of 95% (standard compactive effort). As such, the bulk fill materials would be deemed to be controlled fill that complies with Clause 1.8.13 of AS 2870. Hence, re-classification of the site to account for the fill presence is permitted under Clause 2.5.3 (c) of AS 2870.

LIMITATIONS

The use of this Certificate is only appropriate for the field conditions present up to 21 November 2018.

A handwritten signature in blue ink, appearing to be 'Nick Brock', is written over a light blue circular stamp.

Nick Brock



FILL CERTIFICATE

PROJECT: Lot No 507 (as per Drawing No 12332-5-E-107)
Emerald Park Estate (Stage 5), Tarneit

CLIENT: Winslow Constructors Pty Ltd
50 Barry Road
CAMPBELLFIELD VIC 3061

REPORT NO: 18417_507

DATE: 16 July 2019

SUMMARY

Civil Geotechnical Services were engaged by Winslow Constructors Pty Ltd to provide inspection and testing services on the earthworks associated with the construction of Lot 507 of the Emerald Park Estate (Stage 5), Tarneit in a manner which would satisfy the criteria for Level 1 testing and inspection services as specified in Section 8.2 of AS 3798 - Guidelines on earthworks for commercial and residential developments (2007). The project was classified as Type 1/2 requiring a minimum density ratio of 95.0% (standard compactive effort) within the areas of fill placement.

A site inspection was conducted prior to any fill being placed on the Lot. On the completion of the earthworks and after examining the test results and the materials used, we are of the opinion that the filling procedure conducted by Winslow Constructors Pty Ltd satisfied the requirements of the Level 1 criteria specified in AS 3798 in regard to the placement of fill on a Type 1/2 Project.

Accordingly, when classifying the site in accordance with the procedures presented in Section 2 of AS 2870 – Residential slabs and footings (2011), we are of the view that the bulk fill materials that were placed over this Lot by Winslow Constructors Pty Ltd can be considered as having been placed in a controlled manner to a minimum density ratio of 95% (standard compactive effort). As such, the bulk fill materials would be deemed to be controlled fill that complies with Clause 1.8.13 of AS 2870. Hence, re-classification of the site to account for the fill presence is permitted under Clause 2.5.3 (c) of AS 2870.

LIMITATIONS

The use of this Certificate is only appropriate for the field conditions present up to 21 November 2018.

A handwritten signature in blue ink, appearing to read 'Nick Brock', is written over a light blue circular stamp.

Nick Brock



FILL CERTIFICATE

PROJECT: Lot No 508 (as per Drawing No 12332-5-E-107)
Emerald Park Estate (Stage 5), Tarneit

CLIENT: Winslow Constructors Pty Ltd
50 Barry Road
CAMPBELLFIELD VIC 3061

REPORT NO: 18417_508

DATE: 16 July 2019

SUMMARY

Civil Geotechnical Services were engaged by Winslow Constructors Pty Ltd to provide inspection and testing services on the earthworks associated with the construction of Lot 508 of the Emerald Park Estate (Stage 5), Tarneit in a manner which would satisfy the criteria for Level 1 testing and inspection services as specified in Section 8.2 of AS 3798 - Guidelines on earthworks for commercial and residential developments (2007). The project was classified as Type 1/2 requiring a minimum density ratio of 95.0% (standard compactive effort) within the areas of fill placement.

A site inspection was conducted prior to any fill being placed on the Lot. On the completion of the earthworks and after examining the test results and the materials used, we are of the opinion that the filling procedure conducted by Winslow Constructors Pty Ltd satisfied the requirements of the Level 1 criteria specified in AS 3798 in regard to the placement of fill on a Type 1/2 Project.

Accordingly, when classifying the site in accordance with the procedures presented in Section 2 of AS 2870 – Residential slabs and footings (2011), we are of the view that the bulk fill materials that were placed over this Lot by Winslow Constructors Pty Ltd can be considered as having been placed in a controlled manner to a minimum density ratio of 95% (standard compactive effort). As such, the bulk fill materials would be deemed to be controlled fill that complies with Clause 1.8.13 of AS 2870. Hence, re-classification of the site to account for the fill presence is permitted under Clause 2.5.3 (c) of AS 2870.

LIMITATIONS

The use of this Certificate is only appropriate for the field conditions present up to 21 November 2018.

A handwritten signature in blue ink, appearing to read 'Nick Brock', is written over a light blue circular stamp.

Nick Brock



FILL CERTIFICATE

PROJECT: Lot No 509 (as per Drawing No 12332-5-E-107)
Emerald Park Estate (Stage 5), Tarneit

CLIENT: Winslow Constructors Pty Ltd
50 Barry Road
CAMPBELLFIELD VIC 3061

REPORT NO: 18417_509

DATE: 16 July 2019

SUMMARY

Civil Geotechnical Services were engaged by Winslow Constructors Pty Ltd to provide inspection and testing services on the earthworks associated with the construction of Lot 509 of the Emerald Park Estate (Stage 5), Tarneit in a manner which would satisfy the criteria for Level 1 testing and inspection services as specified in Section 8.2 of AS 3798 - Guidelines on earthworks for commercial and residential developments (2007). The project was classified as Type 1/2 requiring a minimum density ratio of 95.0% (standard compactive effort) within the areas of fill placement.

A site inspection was conducted prior to any fill being placed on the Lot. On the completion of the earthworks and after examining the test results and the materials used, we are of the opinion that the filling procedure conducted by Winslow Constructors Pty Ltd satisfied the requirements of the Level 1 criteria specified in AS 3798 in regard to the placement of fill on a Type 1/2 Project.

Accordingly, when classifying the site in accordance with the procedures presented in Section 2 of AS 2870 – Residential slabs and footings (2011), we are of the view that the bulk fill materials that were placed over this Lot by Winslow Constructors Pty Ltd can be considered as having been placed in a controlled manner to a minimum density ratio of 95% (standard compactive effort). As such, the bulk fill materials would be deemed to be controlled fill that complies with Clause 1.8.13 of AS 2870. Hence, re-classification of the site to account for the fill presence is permitted under Clause 2.5.3 (c) of AS 2870.

LIMITATIONS

The use of this Certificate is only appropriate for the field conditions present up to 21 November 2018.

A handwritten signature in blue ink, appearing to be 'Nick Brock', is written over a light blue circular stamp.

Nick Brock



FILL CERTIFICATE

PROJECT: Lot No 511 (as per Drawing No 12332-5-E-107)
Emerald Park Estate (Stage 5), Tarneit

CLIENT: Winslow Constructors Pty Ltd
50 Barry Road
CAMPBELLFIELD VIC 3061

REPORT NO: 18417_511

DATE: 16 July 2019

SUMMARY

Civil Geotechnical Services were engaged by Winslow Constructors Pty Ltd to provide inspection and testing services on the earthworks associated with the construction of Lot 511 of the Emerald Park Estate (Stage 5), Tarneit in a manner which would satisfy the criteria for Level 1 testing and inspection services as specified in Section 8.2 of AS 3798 - Guidelines on earthworks for commercial and residential developments (2007). The project was classified as Type 1/2 requiring a minimum density ratio of 95.0% (standard compactive effort) within the areas of fill placement.

A site inspection was conducted prior to any fill being placed on the Lot. On the completion of the earthworks and after examining the test results and the materials used, we are of the opinion that the filling procedure conducted by Winslow Constructors Pty Ltd satisfied the requirements of the Level 1 criteria specified in AS 3798 in regard to the placement of fill on a Type 1/2 Project.

Accordingly, when classifying the site in accordance with the procedures presented in Section 2 of AS 2870 – Residential slabs and footings (2011), we are of the view that the bulk fill materials that were placed over this Lot by Winslow Constructors Pty Ltd can be considered as having been placed in a controlled manner to a minimum density ratio of 95% (standard compactive effort). As such, the bulk fill materials would be deemed to be controlled fill that complies with Clause 1.8.13 of AS 2870. Hence, re-classification of the site to account for the fill presence is permitted under Clause 2.5.3 (c) of AS 2870.

LIMITATIONS

The use of this Certificate is only appropriate for the field conditions present up to 21 November 2018.

A handwritten signature in blue ink, appearing to read 'Nick Brock', is written over a light blue circular stamp.

Nick Brock



FILL CERTIFICATE

PROJECT: Lot No 512 (as per Drawing No 12332-5-E-107)
Emerald Park Estate (Stage 5), Tarneit

CLIENT: Winslow Constructors Pty Ltd
50 Barry Road
CAMPBELLFIELD VIC 3061

REPORT NO: 18417_512

DATE: 16 July 2019

SUMMARY

Civil Geotechnical Services were engaged by Winslow Constructors Pty Ltd to provide inspection and testing services on the earthworks associated with the construction of Lot 512 of the Emerald Park Estate (Stage 5), Tarneit in a manner which would satisfy the criteria for Level 1 testing and inspection services as specified in Section 8.2 of AS 3798 - Guidelines on earthworks for commercial and residential developments (2007). The project was classified as Type 1/2 requiring a minimum density ratio of 95.0% (standard compactive effort) within the areas of fill placement.

A site inspection was conducted prior to any fill being placed on the Lot. On the completion of the earthworks and after examining the test results and the materials used, we are of the opinion that the filling procedure conducted by Winslow Constructors Pty Ltd satisfied the requirements of the Level 1 criteria specified in AS 3798 in regard to the placement of fill on a Type 1/2 Project.

Accordingly, when classifying the site in accordance with the procedures presented in Section 2 of AS 2870 – Residential slabs and footings (2011), we are of the view that the bulk fill materials that were placed over this Lot by Winslow Constructors Pty Ltd can be considered as having been placed in a controlled manner to a minimum density ratio of 95% (standard compactive effort). As such, the bulk fill materials would be deemed to be controlled fill that complies with Clause 1.8.13 of AS 2870. Hence, re-classification of the site to account for the fill presence is permitted under Clause 2.5.3 (c) of AS 2870.

LIMITATIONS

The use of this Certificate is only appropriate for the field conditions present up to 21 November 2018.

A handwritten signature in blue ink, appearing to read 'Nick Brock', is written over a light blue circular stamp.

Nick Brock



FILL CERTIFICATE

PROJECT: Lot No 513 (as per Drawing No 12332-5-E-107)
Emerald Park Estate (Stage 5), Tarneit

CLIENT: Winslow Constructors Pty Ltd
50 Barry Road
CAMPBELLFIELD VIC 3061

REPORT NO: 18417_513

DATE: 16 July 2019

SUMMARY

Civil Geotechnical Services were engaged by Winslow Constructors Pty Ltd to provide inspection and testing services on the earthworks associated with the construction of Lot 513 of the Emerald Park Estate (Stage 5), Tarneit in a manner which would satisfy the criteria for Level 1 testing and inspection services as specified in Section 8.2 of AS 3798 - Guidelines on earthworks for commercial and residential developments (2007). The project was classified as Type 1/2 requiring a minimum density ratio of 95.0% (standard compactive effort) within the areas of fill placement.

A site inspection was conducted prior to any fill being placed on the Lot. On the completion of the earthworks and after examining the test results and the materials used, we are of the opinion that the filling procedure conducted by Winslow Constructors Pty Ltd satisfied the requirements of the Level 1 criteria specified in AS 3798 in regard to the placement of fill on a Type 1/2 Project.

Accordingly, when classifying the site in accordance with the procedures presented in Section 2 of AS 2870 – Residential slabs and footings (2011), we are of the view that the bulk fill materials that were placed over this Lot by Winslow Constructors Pty Ltd can be considered as having been placed in a controlled manner to a minimum density ratio of 95% (standard compactive effort). As such, the bulk fill materials would be deemed to be controlled fill that complies with Clause 1.8.13 of AS 2870. Hence, re-classification of the site to account for the fill presence is permitted under Clause 2.5.3 (c) of AS 2870.

LIMITATIONS

The use of this Certificate is only appropriate for the field conditions present up to 21 November 2018.

A handwritten signature in blue ink, appearing to read 'Nick Brock', is written over a light blue circular stamp.

Nick Brock



FILL CERTIFICATE

PROJECT: Lot No 514 (as per Drawing No 12332-5-E-107)
Emerald Park Estate (Stage 5), Tarneit

CLIENT: Winslow Constructors Pty Ltd
50 Barry Road
CAMPBELLFIELD VIC 3061

REPORT NO: 18417_514

DATE: 16 July 2019

SUMMARY

Civil Geotechnical Services were engaged by Winslow Constructors Pty Ltd to provide inspection and testing services on the earthworks associated with the construction of Lot 514 of the Emerald Park Estate (Stage 5), Tarneit in a manner which would satisfy the criteria for Level 1 testing and inspection services as specified in Section 8.2 of AS 3798 - Guidelines on earthworks for commercial and residential developments (2007). The project was classified as Type 1/2 requiring a minimum density ratio of 95.0% (standard compactive effort) within the areas of fill placement.

A site inspection was conducted prior to any fill being placed on the Lot. On the completion of the earthworks and after examining the test results and the materials used, we are of the opinion that the filling procedure conducted by Winslow Constructors Pty Ltd satisfied the requirements of the Level 1 criteria specified in AS 3798 in regard to the placement of fill on a Type 1/2 Project.

Accordingly, when classifying the site in accordance with the procedures presented in Section 2 of AS 2870 – Residential slabs and footings (2011), we are of the view that the bulk fill materials that were placed over this Lot by Winslow Constructors Pty Ltd can be considered as having been placed in a controlled manner to a minimum density ratio of 95% (standard compactive effort). As such, the bulk fill materials would be deemed to be controlled fill that complies with Clause 1.8.13 of AS 2870. Hence, re-classification of the site to account for the fill presence is permitted under Clause 2.5.3 (c) of AS 2870.

LIMITATIONS

The use of this Certificate is only appropriate for the field conditions present up to 21 November 2018.

A handwritten signature in blue ink, appearing to read 'Nick Brock', is written over a light blue circular stamp.

Nick Brock



FILL CERTIFICATE

PROJECT: Lot No 515 (as per Drawing No 12332-5-E-107)
Emerald Park Estate (Stage 5), Tarneit

CLIENT: Winslow Constructors Pty Ltd
50 Barry Road
CAMPBELLFIELD VIC 3061

REPORT NO: 18417_515

DATE: 16 July 2019

SUMMARY

Civil Geotechnical Services were engaged by Winslow Constructors Pty Ltd to provide inspection and testing services on the earthworks associated with the construction of Lot 515 of the Emerald Park Estate (Stage 5), Tarneit in a manner which would satisfy the criteria for Level 1 testing and inspection services as specified in Section 8.2 of AS 3798 - Guidelines on earthworks for commercial and residential developments (2007). The project was classified as Type 1/2 requiring a minimum density ratio of 95.0% (standard compactive effort) within the areas of fill placement.

A site inspection was conducted prior to any fill being placed on the Lot. On the completion of the earthworks and after examining the test results and the materials used, we are of the opinion that the filling procedure conducted by Winslow Constructors Pty Ltd satisfied the requirements of the Level 1 criteria specified in AS 3798 in regard to the placement of fill on a Type 1/2 Project.

Accordingly, when classifying the site in accordance with the procedures presented in Section 2 of AS 2870 – Residential slabs and footings (2011), we are of the view that the bulk fill materials that were placed over this Lot by Winslow Constructors Pty Ltd can be considered as having been placed in a controlled manner to a minimum density ratio of 95% (standard compactive effort). As such, the bulk fill materials would be deemed to be controlled fill that complies with Clause 1.8.13 of AS 2870. Hence, re-classification of the site to account for the fill presence is permitted under Clause 2.5.3 (c) of AS 2870.

LIMITATIONS

The use of this Certificate is only appropriate for the field conditions present up to 21 November 2018.

A handwritten signature in blue ink, appearing to read 'Nick Brock', is written over a light blue circular stamp.

Nick Brock



FILL CERTIFICATE

PROJECT: Lot No 516 (as per Drawing No 12332-5-E-107)
Emerald Park Estate (Stage 5), Tarneit

CLIENT: Winslow Constructors Pty Ltd
50 Barry Road
CAMPBELLFIELD VIC 3061

REPORT NO: 18417_516

DATE: 16 July 2019

SUMMARY

Civil Geotechnical Services were engaged by Winslow Constructors Pty Ltd to provide inspection and testing services on the earthworks associated with the construction of Lot 516 of the Emerald Park Estate (Stage 5), Tarneit in a manner which would satisfy the criteria for Level 1 testing and inspection services as specified in Section 8.2 of AS 3798 - Guidelines on earthworks for commercial and residential developments (2007). The project was classified as Type 1/2 requiring a minimum density ratio of 95.0% (standard compactive effort) within the areas of fill placement.

A site inspection was conducted prior to any fill being placed on the Lot. On the completion of the earthworks and after examining the test results and the materials used, we are of the opinion that the filling procedure conducted by Winslow Constructors Pty Ltd satisfied the requirements of the Level 1 criteria specified in AS 3798 in regard to the placement of fill on a Type 1/2 Project.

Accordingly, when classifying the site in accordance with the procedures presented in Section 2 of AS 2870 – Residential slabs and footings (2011), we are of the view that the bulk fill materials that were placed over this Lot by Winslow Constructors Pty Ltd can be considered as having been placed in a controlled manner to a minimum density ratio of 95% (standard compactive effort). As such, the bulk fill materials would be deemed to be controlled fill that complies with Clause 1.8.13 of AS 2870. Hence, re-classification of the site to account for the fill presence is permitted under Clause 2.5.3 (c) of AS 2870.

LIMITATIONS

The use of this Certificate is only appropriate for the field conditions present up to 21 November 2018.

A handwritten signature in blue ink, appearing to read 'Nick Brock', is written over a light blue circular stamp.

Nick Brock



FILL CERTIFICATE

PROJECT: Lot No 517 (as per Drawing No 12332-5-E-107)
Emerald Park Estate (Stage 5), Tarneit

CLIENT: Winslow Constructors Pty Ltd
50 Barry Road
CAMPBELLFIELD VIC 3061

REPORT NO: 18417_517

DATE: 16 July 2019

SUMMARY

Civil Geotechnical Services were engaged by Winslow Constructors Pty Ltd to provide inspection and testing services on the earthworks associated with the construction of Lot 517 of the Emerald Park Estate (Stage 5), Tarneit in a manner which would satisfy the criteria for Level 1 testing and inspection services as specified in Section 8.2 of AS 3798 - Guidelines on earthworks for commercial and residential developments (2007). The project was classified as Type 1/2 requiring a minimum density ratio of 95.0% (standard compactive effort) within the areas of fill placement.

A site inspection was conducted prior to any fill being placed on the Lot. On the completion of the earthworks and after examining the test results and the materials used, we are of the opinion that the filling procedure conducted by Winslow Constructors Pty Ltd satisfied the requirements of the Level 1 criteria specified in AS 3798 in regard to the placement of fill on a Type 1/2 Project.

Accordingly, when classifying the site in accordance with the procedures presented in Section 2 of AS 2870 – Residential slabs and footings (2011), we are of the view that the bulk fill materials that were placed over this Lot by Winslow Constructors Pty Ltd can be considered as having been placed in a controlled manner to a minimum density ratio of 95% (standard compactive effort). As such, the bulk fill materials would be deemed to be controlled fill that complies with Clause 1.8.13 of AS 2870. Hence, re-classification of the site to account for the fill presence is permitted under Clause 2.5.3 (c) of AS 2870.

LIMITATIONS

The use of this Certificate is only appropriate for the field conditions present up to 21 November 2018.

A handwritten signature in blue ink, appearing to be 'Nick Brock', is written over a light blue circular stamp.

Nick Brock



FILL CERTIFICATE

PROJECT: Lot No 518 (as per Drawing No 12332-5-E-107)
Emerald Park Estate (Stage 5), Tarneit

CLIENT: Winslow Constructors Pty Ltd
50 Barry Road
CAMPBELLFIELD VIC 3061

REPORT NO: 18417_518

DATE: 16 July 2019

SUMMARY

Civil Geotechnical Services were engaged by Winslow Constructors Pty Ltd to provide inspection and testing services on the earthworks associated with the construction of Lot 518 of the Emerald Park Estate (Stage 5), Tarneit in a manner which would satisfy the criteria for Level 1 testing and inspection services as specified in Section 8.2 of AS 3798 - Guidelines on earthworks for commercial and residential developments (2007). The project was classified as Type 1/2 requiring a minimum density ratio of 95.0% (standard compactive effort) within the areas of fill placement.

A site inspection was conducted prior to any fill being placed on the Lot. On the completion of the earthworks and after examining the test results and the materials used, we are of the opinion that the filling procedure conducted by Winslow Constructors Pty Ltd satisfied the requirements of the Level 1 criteria specified in AS 3798 in regard to the placement of fill on a Type 1/2 Project.

Accordingly, when classifying the site in accordance with the procedures presented in Section 2 of AS 2870 – Residential slabs and footings (2011), we are of the view that the bulk fill materials that were placed over this Lot by Winslow Constructors Pty Ltd can be considered as having been placed in a controlled manner to a minimum density ratio of 95% (standard compactive effort). As such, the bulk fill materials would be deemed to be controlled fill that complies with Clause 1.8.13 of AS 2870. Hence, re-classification of the site to account for the fill presence is permitted under Clause 2.5.3 (c) of AS 2870.

LIMITATIONS

The use of this Certificate is only appropriate for the field conditions present up to 21 November 2018.

A handwritten signature in blue ink, appearing to read 'Nick Brock', is written over a light blue circular stamp.

Nick Brock



FILL CERTIFICATE

PROJECT: Lot No 519 (as per Drawing No 12332-5-E-107)
Emerald Park Estate (Stage 5), Tarneit

CLIENT: Winslow Constructors Pty Ltd
50 Barry Road
CAMPBELLFIELD VIC 3061

REPORT NO: 18417_519

DATE: 16 July 2019

SUMMARY

Civil Geotechnical Services were engaged by Winslow Constructors Pty Ltd to provide inspection and testing services on the earthworks associated with the construction of Lot 519 of the Emerald Park Estate (Stage 5), Tarneit in a manner which would satisfy the criteria for Level 1 testing and inspection services as specified in Section 8.2 of AS 3798 - Guidelines on earthworks for commercial and residential developments (2007). The project was classified as Type 1/2 requiring a minimum density ratio of 95.0% (standard compactive effort) within the areas of fill placement.

A site inspection was conducted prior to any fill being placed on the Lot. On the completion of the earthworks and after examining the test results and the materials used, we are of the opinion that the filling procedure conducted by Winslow Constructors Pty Ltd satisfied the requirements of the Level 1 criteria specified in AS 3798 in regard to the placement of fill on a Type 1/2 Project.

Accordingly, when classifying the site in accordance with the procedures presented in Section 2 of AS 2870 – Residential slabs and footings (2011), we are of the view that the bulk fill materials that were placed over this Lot by Winslow Constructors Pty Ltd can be considered as having been placed in a controlled manner to a minimum density ratio of 95% (standard compactive effort). As such, the bulk fill materials would be deemed to be controlled fill that complies with Clause 1.8.13 of AS 2870. Hence, re-classification of the site to account for the fill presence is permitted under Clause 2.5.3 (c) of AS 2870.

LIMITATIONS

The use of this Certificate is only appropriate for the field conditions present up to 21 November 2018.

A handwritten signature in blue ink, appearing to read 'Nick Brock', is written over a light blue circular stamp.

Nick Brock



FILL CERTIFICATE

PROJECT: Lot No 520 (as per Drawing No 12332-5-E-107)
Emerald Park Estate (Stage 5), Tarneit

CLIENT: Winslow Constructors Pty Ltd
50 Barry Road
CAMPBELLFIELD VIC 3061

REPORT NO: 18417_520

DATE: 16 July 2019

SUMMARY

Civil Geotechnical Services were engaged by Winslow Constructors Pty Ltd to provide inspection and testing services on the earthworks associated with the construction of Lot 520 of the Emerald Park Estate (Stage 5), Tarneit in a manner which would satisfy the criteria for Level 1 testing and inspection services as specified in Section 8.2 of AS 3798 - Guidelines on earthworks for commercial and residential developments (2007). The project was classified as Type 1/2 requiring a minimum density ratio of 95.0% (standard compactive effort) within the areas of fill placement.

A site inspection was conducted prior to any fill being placed on the Lot. On the completion of the earthworks and after examining the test results and the materials used, we are of the opinion that the filling procedure conducted by Winslow Constructors Pty Ltd satisfied the requirements of the Level 1 criteria specified in AS 3798 in regard to the placement of fill on a Type 1/2 Project.

Accordingly, when classifying the site in accordance with the procedures presented in Section 2 of AS 2870 – Residential slabs and footings (2011), we are of the view that the bulk fill materials that were placed over this Lot by Winslow Constructors Pty Ltd can be considered as having been placed in a controlled manner to a minimum density ratio of 95% (standard compactive effort). As such, the bulk fill materials would be deemed to be controlled fill that complies with Clause 1.8.13 of AS 2870. Hence, re-classification of the site to account for the fill presence is permitted under Clause 2.5.3 (c) of AS 2870.

LIMITATIONS

The use of this Certificate is only appropriate for the field conditions present up to 21 November 2018.

A handwritten signature in blue ink, appearing to read 'Nick Brock', is written over a light blue circular stamp.

Nick Brock



FILL CERTIFICATE

PROJECT: Lot No 525 (as per Drawing No 12332-5-E-107)
Emerald Park Estate (Stage 5), Tarneit

CLIENT: Winslow Constructors Pty Ltd
50 Barry Road
CAMPBELLFIELD VIC 3061

REPORT NO: 18417_525

DATE: 16 July 2019

SUMMARY

Civil Geotechnical Services were engaged by Winslow Constructors Pty Ltd to provide inspection and testing services on the earthworks associated with the construction of Lot 525 of the Emerald Park Estate (Stage 5), Tarneit in a manner which would satisfy the criteria for Level 1 testing and inspection services as specified in Section 8.2 of AS 3798 - Guidelines on earthworks for commercial and residential developments (2007). The project was classified as Type 1/2 requiring a minimum density ratio of 95.0% (standard compactive effort) within the areas of fill placement.

A site inspection was conducted prior to any fill being placed on the Lot. On the completion of the earthworks and after examining the test results and the materials used, we are of the opinion that the filling procedure conducted by Winslow Constructors Pty Ltd satisfied the requirements of the Level 1 criteria specified in AS 3798 in regard to the placement of fill on a Type 1/2 Project.

Accordingly, when classifying the site in accordance with the procedures presented in Section 2 of AS 2870 – Residential slabs and footings (2011), we are of the view that the bulk fill materials that were placed over this Lot by Winslow Constructors Pty Ltd can be considered as having been placed in a controlled manner to a minimum density ratio of 95% (standard compactive effort). As such, the bulk fill materials would be deemed to be controlled fill that complies with Clause 1.8.13 of AS 2870. Hence, re-classification of the site to account for the fill presence is permitted under Clause 2.5.3 (c) of AS 2870.

LIMITATIONS

The use of this Certificate is only appropriate for the field conditions present up to 21 November 2018.

A handwritten signature in blue ink, appearing to read 'Nick Brock', is written over a light blue circular stamp.

Nick Brock



FILL CERTIFICATE

PROJECT: Lot No 526 (as per Drawing No 12332-5-E-107)
Emerald Park Estate (Stage 5), Tarneit

CLIENT: Winslow Constructors Pty Ltd
50 Barry Road
CAMPBELLFIELD VIC 3061

REPORT NO: 18417_526

DATE: 16 July 2019

SUMMARY

Civil Geotechnical Services were engaged by Winslow Constructors Pty Ltd to provide inspection and testing services on the earthworks associated with the construction of Lot 526 of the Emerald Park Estate (Stage 5), Tarneit in a manner which would satisfy the criteria for Level 1 testing and inspection services as specified in Section 8.2 of AS 3798 - Guidelines on earthworks for commercial and residential developments (2007). The project was classified as Type 1/2 requiring a minimum density ratio of 95.0% (standard compactive effort) within the areas of fill placement.

A site inspection was conducted prior to any fill being placed on the Lot. On the completion of the earthworks and after examining the test results and the materials used, we are of the opinion that the filling procedure conducted by Winslow Constructors Pty Ltd satisfied the requirements of the Level 1 criteria specified in AS 3798 in regard to the placement of fill on a Type 1/2 Project.

Accordingly, when classifying the site in accordance with the procedures presented in Section 2 of AS 2870 – Residential slabs and footings (2011), we are of the view that the bulk fill materials that were placed over this Lot by Winslow Constructors Pty Ltd can be considered as having been placed in a controlled manner to a minimum density ratio of 95% (standard compactive effort). As such, the bulk fill materials would be deemed to be controlled fill that complies with Clause 1.8.13 of AS 2870. Hence, re-classification of the site to account for the fill presence is permitted under Clause 2.5.3 (c) of AS 2870.

LIMITATIONS

The use of this Certificate is only appropriate for the field conditions present up to 21 November 2018.

A handwritten signature in blue ink, appearing to read 'Nick Brock', is written over a light blue circular stamp.

Nick Brock



FILL CERTIFICATE

PROJECT: Lot No 527 (as per Drawing No 12332-5-E-107)
Emerald Park Estate (Stage 5), Tarneit

CLIENT: Winslow Constructors Pty Ltd
50 Barry Road
CAMPBELLFIELD VIC 3061

REPORT NO: 18417_527

DATE: 16 July 2019

SUMMARY

Civil Geotechnical Services were engaged by Winslow Constructors Pty Ltd to provide inspection and testing services on the earthworks associated with the construction of Lot 527 of the Emerald Park Estate (Stage 5), Tarneit in a manner which would satisfy the criteria for Level 1 testing and inspection services as specified in Section 8.2 of AS 3798 - Guidelines on earthworks for commercial and residential developments (2007). The project was classified as Type 1/2 requiring a minimum density ratio of 95.0% (standard compactive effort) within the areas of fill placement.

A site inspection was conducted prior to any fill being placed on the Lot. On the completion of the earthworks and after examining the test results and the materials used, we are of the opinion that the filling procedure conducted by Winslow Constructors Pty Ltd satisfied the requirements of the Level 1 criteria specified in AS 3798 in regard to the placement of fill on a Type 1/2 Project.

Accordingly, when classifying the site in accordance with the procedures presented in Section 2 of AS 2870 – Residential slabs and footings (2011), we are of the view that the bulk fill materials that were placed over this Lot by Winslow Constructors Pty Ltd can be considered as having been placed in a controlled manner to a minimum density ratio of 95% (standard compactive effort). As such, the bulk fill materials would be deemed to be controlled fill that complies with Clause 1.8.13 of AS 2870. Hence, re-classification of the site to account for the fill presence is permitted under Clause 2.5.3 (c) of AS 2870.

LIMITATIONS

The use of this Certificate is only appropriate for the field conditions present up to 21 November 2018.

A handwritten signature in blue ink, appearing to read 'Nick Brock', is written over a light blue circular stamp.

Nick Brock



FILL CERTIFICATE

PROJECT: Lot No 528 (as per Drawing No 12332-5-E-107)
Emerald Park Estate (Stage 5), Tarneit

CLIENT: Winslow Constructors Pty Ltd
50 Barry Road
CAMPBELLFIELD VIC 3061

REPORT NO: 18417_528

DATE: 16 July 2019

SUMMARY

Civil Geotechnical Services were engaged by Winslow Constructors Pty Ltd to provide inspection and testing services on the earthworks associated with the construction of Lot 528 of the Emerald Park Estate (Stage 5), Tarneit in a manner which would satisfy the criteria for Level 1 testing and inspection services as specified in Section 8.2 of AS 3798 - Guidelines on earthworks for commercial and residential developments (2007). The project was classified as Type 1/2 requiring a minimum density ratio of 95.0% (standard compactive effort) within the areas of fill placement.

A site inspection was conducted prior to any fill being placed on the Lot. On the completion of the earthworks and after examining the test results and the materials used, we are of the opinion that the filling procedure conducted by Winslow Constructors Pty Ltd satisfied the requirements of the Level 1 criteria specified in AS 3798 in regard to the placement of fill on a Type 1/2 Project.

Accordingly, when classifying the site in accordance with the procedures presented in Section 2 of AS 2870 – Residential slabs and footings (2011), we are of the view that the bulk fill materials that were placed over this Lot by Winslow Constructors Pty Ltd can be considered as having been placed in a controlled manner to a minimum density ratio of 95% (standard compactive effort). As such, the bulk fill materials would be deemed to be controlled fill that complies with Clause 1.8.13 of AS 2870. Hence, re-classification of the site to account for the fill presence is permitted under Clause 2.5.3 (c) of AS 2870.

LIMITATIONS

The use of this Certificate is only appropriate for the field conditions present up to 21 November 2018.

A handwritten signature in blue ink, appearing to read 'Nick Brock', is written over a light blue circular stamp.

Nick Brock



FILL CERTIFICATE

PROJECT: Lot No 529 (as per Drawing No 12332-5-E-107)
Emerald Park Estate (Stage 5), Tarneit

CLIENT: Winslow Constructors Pty Ltd
50 Barry Road
CAMPBELLFIELD VIC 3061

REPORT NO: 18417_529

DATE: 16 July 2019

SUMMARY

Civil Geotechnical Services were engaged by Winslow Constructors Pty Ltd to provide inspection and testing services on the earthworks associated with the construction of Lot 529 of the Emerald Park Estate (Stage 5), Tarneit in a manner which would satisfy the criteria for Level 1 testing and inspection services as specified in Section 8.2 of AS 3798 - Guidelines on earthworks for commercial and residential developments (2007). The project was classified as Type 1/2 requiring a minimum density ratio of 95.0% (standard compactive effort) within the areas of fill placement.

A site inspection was conducted prior to any fill being placed on the Lot. On the completion of the earthworks and after examining the test results and the materials used, we are of the opinion that the filling procedure conducted by Winslow Constructors Pty Ltd satisfied the requirements of the Level 1 criteria specified in AS 3798 in regard to the placement of fill on a Type 1/2 Project.

Accordingly, when classifying the site in accordance with the procedures presented in Section 2 of AS 2870 – Residential slabs and footings (2011), we are of the view that the bulk fill materials that were placed over this Lot by Winslow Constructors Pty Ltd can be considered as having been placed in a controlled manner to a minimum density ratio of 95% (standard compactive effort). As such, the bulk fill materials would be deemed to be controlled fill that complies with Clause 1.8.13 of AS 2870. Hence, re-classification of the site to account for the fill presence is permitted under Clause 2.5.3 (c) of AS 2870.

LIMITATIONS

The use of this Certificate is only appropriate for the field conditions present up to 21 November 2018.

A handwritten signature in blue ink, appearing to read 'Nick Brock', is written over a light blue circular stamp.

Nick Brock



FILL CERTIFICATE

PROJECT: Lot No 530 (as per Drawing No 12332-5-E-107)
Emerald Park Estate (Stage 5), Tarneit

CLIENT: Winslow Constructors Pty Ltd
50 Barry Road
CAMPBELLFIELD VIC 3061

REPORT NO: 18417_530

DATE: 16 July 2019

SUMMARY

Civil Geotechnical Services were engaged by Winslow Constructors Pty Ltd to provide inspection and testing services on the earthworks associated with the construction of Lot 530 of the Emerald Park Estate (Stage 5), Tarneit in a manner which would satisfy the criteria for Level 1 testing and inspection services as specified in Section 8.2 of AS 3798 - Guidelines on earthworks for commercial and residential developments (2007). The project was classified as Type 1/2 requiring a minimum density ratio of 95.0% (standard compactive effort) within the areas of fill placement.

A site inspection was conducted prior to any fill being placed on the Lot. On the completion of the earthworks and after examining the test results and the materials used, we are of the opinion that the filling procedure conducted by Winslow Constructors Pty Ltd satisfied the requirements of the Level 1 criteria specified in AS 3798 in regard to the placement of fill on a Type 1/2 Project.

Accordingly, when classifying the site in accordance with the procedures presented in Section 2 of AS 2870 – Residential slabs and footings (2011), we are of the view that the bulk fill materials that were placed over this Lot by Winslow Constructors Pty Ltd can be considered as having been placed in a controlled manner to a minimum density ratio of 95% (standard compactive effort). As such, the bulk fill materials would be deemed to be controlled fill that complies with Clause 1.8.13 of AS 2870. Hence, re-classification of the site to account for the fill presence is permitted under Clause 2.5.3 (c) of AS 2870.

LIMITATIONS

The use of this Certificate is only appropriate for the field conditions present up to 21 November 2018.

A handwritten signature in blue ink, appearing to be 'Nick Brock', is written over a light blue circular stamp.

Nick Brock



FILL CERTIFICATE

PROJECT: Lot No 531 (as per Drawing No 12332-5-E-107)
Emerald Park Estate (Stage 5), Tarneit

CLIENT: Winslow Constructors Pty Ltd
50 Barry Road
CAMPBELLFIELD VIC 3061

REPORT NO: 18417_531

DATE: 16 July 2019

SUMMARY

Civil Geotechnical Services were engaged by Winslow Constructors Pty Ltd to provide inspection and testing services on the earthworks associated with the construction of Lot 531 of the Emerald Park Estate (Stage 5), Tarneit in a manner which would satisfy the criteria for Level 1 testing and inspection services as specified in Section 8.2 of AS 3798 - Guidelines on earthworks for commercial and residential developments (2007). The project was classified as Type 1/2 requiring a minimum density ratio of 95.0% (standard compactive effort) within the areas of fill placement.

A site inspection was conducted prior to any fill being placed on the Lot. On the completion of the earthworks and after examining the test results and the materials used, we are of the opinion that the filling procedure conducted by Winslow Constructors Pty Ltd satisfied the requirements of the Level 1 criteria specified in AS 3798 in regard to the placement of fill on a Type 1/2 Project.

Accordingly, when classifying the site in accordance with the procedures presented in Section 2 of AS 2870 – Residential slabs and footings (2011), we are of the view that the bulk fill materials that were placed over this Lot by Winslow Constructors Pty Ltd can be considered as having been placed in a controlled manner to a minimum density ratio of 95% (standard compactive effort). As such, the bulk fill materials would be deemed to be controlled fill that complies with Clause 1.8.13 of AS 2870. Hence, re-classification of the site to account for the fill presence is permitted under Clause 2.5.3 (c) of AS 2870.

LIMITATIONS

The use of this Certificate is only appropriate for the field conditions present up to 21 November 2018.

A handwritten signature in blue ink, appearing to read 'Nick Brock', is written over a light blue circular stamp.

Nick Brock



FILL CERTIFICATE

PROJECT: Lot No 532 (as per Drawing No 12332-5-E-107)
Emerald Park Estate (Stage 5), Tarneit

CLIENT: Winslow Constructors Pty Ltd
50 Barry Road
CAMPBELLFIELD VIC 3061

REPORT NO: 18417_532

DATE: 16 July 2019

SUMMARY

Civil Geotechnical Services were engaged by Winslow Constructors Pty Ltd to provide inspection and testing services on the earthworks associated with the construction of Lot 532 of the Emerald Park Estate (Stage 5), Tarneit in a manner which would satisfy the criteria for Level 1 testing and inspection services as specified in Section 8.2 of AS 3798 - Guidelines on earthworks for commercial and residential developments (2007). The project was classified as Type 1/2 requiring a minimum density ratio of 95.0% (standard compactive effort) within the areas of fill placement.

A site inspection was conducted prior to any fill being placed on the Lot. On the completion of the earthworks and after examining the test results and the materials used, we are of the opinion that the filling procedure conducted by Winslow Constructors Pty Ltd satisfied the requirements of the Level 1 criteria specified in AS 3798 in regard to the placement of fill on a Type 1/2 Project.

Accordingly, when classifying the site in accordance with the procedures presented in Section 2 of AS 2870 – Residential slabs and footings (2011), we are of the view that the bulk fill materials that were placed over this Lot by Winslow Constructors Pty Ltd can be considered as having been placed in a controlled manner to a minimum density ratio of 95% (standard compactive effort). As such, the bulk fill materials would be deemed to be controlled fill that complies with Clause 1.8.13 of AS 2870. Hence, re-classification of the site to account for the fill presence is permitted under Clause 2.5.3 (c) of AS 2870.

LIMITATIONS

The use of this Certificate is only appropriate for the field conditions present up to 21 November 2018.

A handwritten signature in blue ink, appearing to be 'Nick Brock', is written over a light blue circular stamp.

Nick Brock



FILL CERTIFICATE

PROJECT: Lot No 533 (as per Drawing No 12332-5-E-107)
Emerald Park Estate (Stage 5), Tarneit

CLIENT: Winslow Constructors Pty Ltd
50 Barry Road
CAMPBELLFIELD VIC 3061

REPORT NO: 18417_533

DATE: 16 July 2019

SUMMARY

Civil Geotechnical Services were engaged by Winslow Constructors Pty Ltd to provide inspection and testing services on the earthworks associated with the construction of Lot 533 of the Emerald Park Estate (Stage 5), Tarneit in a manner which would satisfy the criteria for Level 1 testing and inspection services as specified in Section 8.2 of AS 3798 - Guidelines on earthworks for commercial and residential developments (2007). The project was classified as Type 1/2 requiring a minimum density ratio of 95.0% (standard compactive effort) within the areas of fill placement.

A site inspection was conducted prior to any fill being placed on the Lot. On the completion of the earthworks and after examining the test results and the materials used, we are of the opinion that the filling procedure conducted by Winslow Constructors Pty Ltd satisfied the requirements of the Level 1 criteria specified in AS 3798 in regard to the placement of fill on a Type 1/2 Project.

Accordingly, when classifying the site in accordance with the procedures presented in Section 2 of AS 2870 – Residential slabs and footings (2011), we are of the view that the bulk fill materials that were placed over this Lot by Winslow Constructors Pty Ltd can be considered as having been placed in a controlled manner to a minimum density ratio of 95% (standard compactive effort). As such, the bulk fill materials would be deemed to be controlled fill that complies with Clause 1.8.13 of AS 2870. Hence, re-classification of the site to account for the fill presence is permitted under Clause 2.5.3 (c) of AS 2870.

LIMITATIONS

The use of this Certificate is only appropriate for the field conditions present up to 21 November 2018.

A handwritten signature in blue ink, appearing to be 'Nick Brock', is written over a light blue circular stamp.

Nick Brock



FILL CERTIFICATE

PROJECT: Lot No 534 (as per Drawing No 12332-5-E-107)
Emerald Park Estate (Stage 5), Tarneit

CLIENT: Winslow Constructors Pty Ltd
50 Barry Road
CAMPBELLFIELD VIC 3061

REPORT NO: 18417_534

DATE: 16 July 2019

SUMMARY

Civil Geotechnical Services were engaged by Winslow Constructors Pty Ltd to provide inspection and testing services on the earthworks associated with the construction of Lot 534 of the Emerald Park Estate (Stage 5), Tarneit in a manner which would satisfy the criteria for Level 1 testing and inspection services as specified in Section 8.2 of AS 3798 - Guidelines on earthworks for commercial and residential developments (2007). The project was classified as Type 1/2 requiring a minimum density ratio of 95.0% (standard compactive effort) within the areas of fill placement.

A site inspection was conducted prior to any fill being placed on the Lot. On the completion of the earthworks and after examining the test results and the materials used, we are of the opinion that the filling procedure conducted by Winslow Constructors Pty Ltd satisfied the requirements of the Level 1 criteria specified in AS 3798 in regard to the placement of fill on a Type 1/2 Project.

Accordingly, when classifying the site in accordance with the procedures presented in Section 2 of AS 2870 – Residential slabs and footings (2011), we are of the view that the bulk fill materials that were placed over this Lot by Winslow Constructors Pty Ltd can be considered as having been placed in a controlled manner to a minimum density ratio of 95% (standard compactive effort). As such, the bulk fill materials would be deemed to be controlled fill that complies with Clause 1.8.13 of AS 2870. Hence, re-classification of the site to account for the fill presence is permitted under Clause 2.5.3 (c) of AS 2870.

LIMITATIONS

The use of this Certificate is only appropriate for the field conditions present up to 21 November 2018.

A handwritten signature in blue ink, appearing to read 'Nick Brock', is written over a light blue circular stamp.

Nick Brock



CIVIL GEOTECHNICAL SERVICES
ABN 26 474 013 724
PO Box 678 Croydon Vic 3136
Telephone: 9723 0744 Facsimile: 9723 0799

16th July 2019

Our Reference: 18417:NB528

Winslow Constructors Pty Ltd
50 Barry Road
CAMPBELLFIELD VIC 3061

Dear Sirs/Madams,

**RE: LEVEL 1 EARTHWORKS INSPECTION AND TESTING
EMERALD PARK – STAGE 5 (TARNEIT)**

Please find attached our Report No's 18417/R001 to 18417/R004 which relate to the field density testing that was conducted within the filled allotments at the above subdivision. The level 1 inspections and associated field density testing commenced in July 2018 and was completed in November 2018.

The inspections and testing of the earthworks was undertaken in general accordance with the Level 1 requirements of AS 3798 - Guidelines on Earthworks for Commercial and Residential Developments.

The site inspection and testing was performed by experienced geotechnicians from this office. Any areas that were deemed unsatisfactory were reworked and retested under their supervision. The testing was performed to the relevant Australian Standards and the accompanying test reports carry NATA endorsement. The attached compaction results, which were located randomly throughout the fill profile, are considered to be representative of the bulk fill materials that were placed across the reported allotments by Winslow Constructors during the aforementioned period. The approximate locations of the field density tests can be seen on the attached plan (Figure 1).

We are of the view that the bulk fill materials that have been placed across the reported allotments by Winslow Constructors during the aforementioned period can be considered as having been placed in a controlled manner to a minimum density ratio of 95% (standard compactive effort).

Please contact the undersigned if you require any additional information.

Civil Geotechnical Services

A handwritten signature in blue ink, appearing to read 'Nick Brock', is written over a light blue circular stamp.

Nick Brock

FIGURE 1

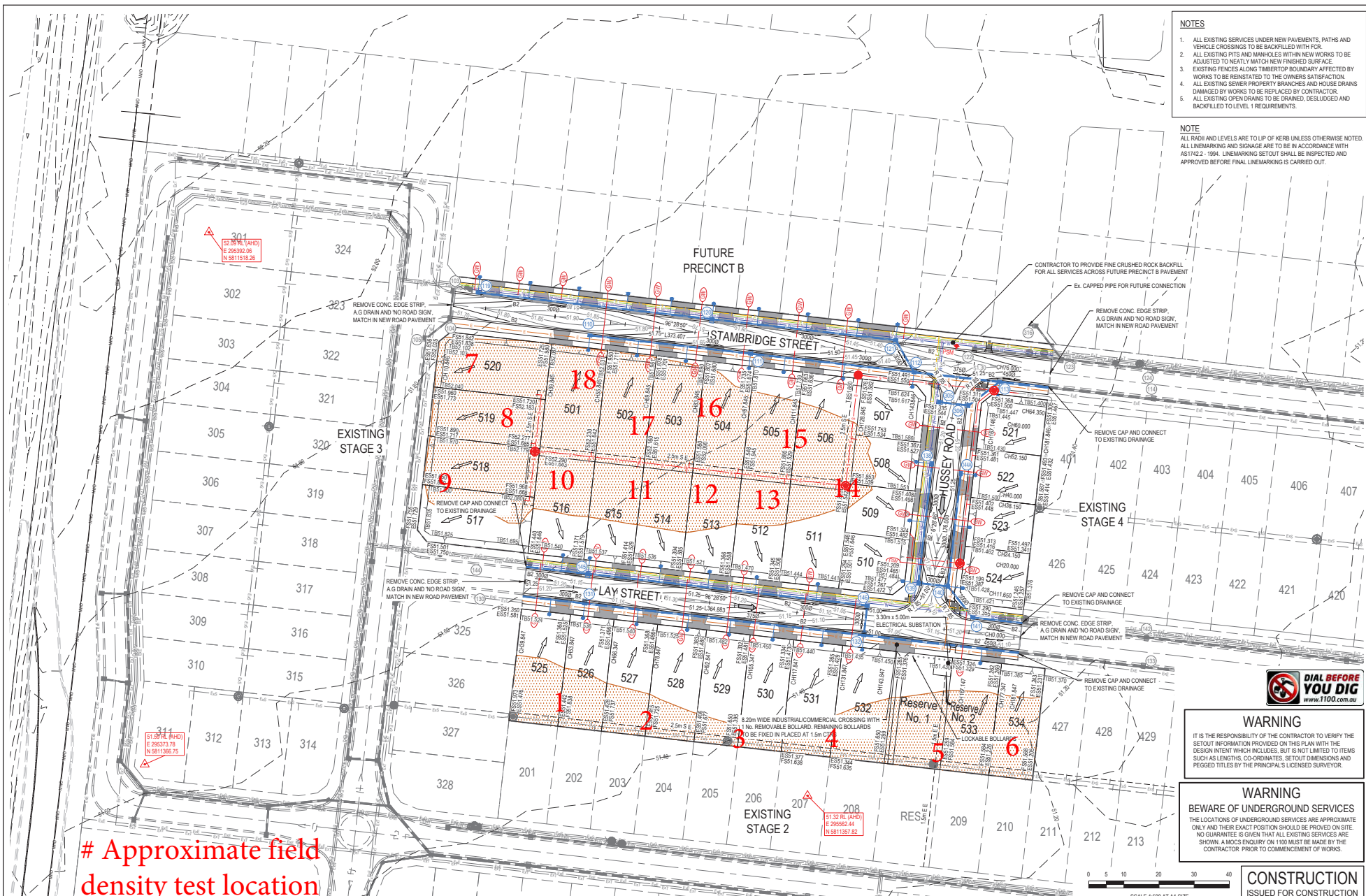

- NOTES**
1. ALL EXISTING SERVICES UNDER NEW PAVEMENTS, PATHS AND VEHICLE CROSSINGS TO BE BACKFILLED WITH FCR.
 2. ALL EXISTING FITS AND BRANCHES WITH NEW WORKS TO BE ADJUSTED TO NEATLY MATCH NEW FINISHED SURFACE.
 3. EXISTING FENCES ALONG TIMBERTOP BOUNDARY AFFECTED BY WORKS TO BE REINSTATED TO THE OWNERS SATISFACTION.
 4. ALL EXISTING SEWER PROPERTY BRANCHES AND HOUSE DRAINS DAMAGED BY WORKS TO BE REPLACED BY CONTRACTOR.
 5. ALL EXISTING OPEN DRAINS TO BE DRAINED, DESLUGGED AND BACKFILLED TO LEVEL 1 REQUIREMENTS.

NOTE
ALL RADII AND LEVELS ARE TO LIP OF KERB UNLESS OTHERWISE NOTED. ALL LINEMARKING AND SIGNAGE ARE TO BE IN ACCORDANCE WITH AUSTRAZ 2-1994. LINEMARKING SETOUT SHALL BE INSPECTED AND APPROVED BEFORE FINAL LINEMARKING IS CARRIED OUT.

Approximate field density test location



WARNING
IT IS THE RESPONSIBILITY OF THE CONTRACTOR TO VERIFY THE SETOUT INFORMATION PROVIDED ON THIS PLAN WITH THE DESIGN INTENT WHICH INCLUDES, BUT IS NOT LIMITED TO ITEMS SUCH AS LENGTHS, CO-ORDINATES, SETOUT DIMENSIONS AND PEGGED TITLES BY THE PRINCIPAL'S LICENSED SURVEYOR.

WARNING
BEWARE OF UNDERGROUND SERVICES
THE LOCATIONS OF UNDERGROUND SERVICES ARE APPROXIMATE ONLY AND THEIR EXACT POSITION SHOULD BE PROVIDED ON SITE. NO GUARANTEE IS GIVEN THAT ALL EXISTING SERVICES ARE SHOWN. A MOCS ENQUIRY ON 1100 MUST BE MADE BY THE CONTRACTOR PRIOR TO COMMENCEMENT OF WORKS.

CONSTRUCTION
ISSUED FOR CONSTRUCTION

<p>19.08.2017 ISSUED FOR CONSTRUCTION</p>		<p>REVISION</p>		<p>APPD.</p>		<p>THE</p>		<p>LEGEND</p>		<p>Coords: MGA Levels: AHD</p>		<p>DESIGNED: TNO CHECKED: AHM</p>		<p>AUTHORISED: JAY AUTH. DATE:</p>		<p>DRAFTED: 12332-5-E-107</p>		<p>SCALE 1:500 AT A1 SIZE</p>		<p>WYNDHAM CITY COUNCIL EMERALD PARK STAGE 5 DETAIL LAYOUT PLAN</p>		<p>SCALE 1:500 @ A1: 1:1000 @ A3 VERSION 0 SHEET 8 OF 19 DRAWING No. 12332-5-E-107</p>																	
<p>Existing Gas Main</p>		<p>Proposed Gas Main</p>		<p>Street Name Sign</p>		<p>Existing Water Main</p>		<p>Proposed Water Main</p>		<p>P.S.M. T.B.M.</p>		<p>Existing Electricity Cable</p>		<p>Proposed Electricity Cable</p>		<p>Existing Telephone Cable</p>		<p>Proposed Telephone Cable</p>		<p>Existing Sewer Main & M.M.</p>		<p>Proposed Sewer Main & M.M.</p>		<p>Existing Drain & Pit</p>		<p>Proposed Drain & Pit</p>		<p>Existing Open Drain</p>		<p>Proposed Open Drain</p>		<p>Existing Finished surface top of batter</p>		<p>Proposed Finished surface top of batter</p>		<p>Existing Filling on site deeper than 200mm</p>		<p>Proposed Filling on site deeper than 200mm</p>	



WYNDHAM CITY COUNCIL
EMERALD PARK STAGE 5
DETAIL LAYOUT PLAN

SCALE 1:500 @ A1: 1:1000 @ A3
VERSION 0
SHEET 8 OF 19
DRAWING No.
12332-5-E-107



COMPACTION ASSESSMENT

Job No 18417
 Report No 18417/R001
 Date Issued 16/10/2018

CIVIL GEOTECHNICAL SERVICES

6 - 8 Rose Avenue, Croydon 3136

Client	WINSLOW CONSTRUCTORS PTY LTD (CAMPBELLFIELD)	Tested by	JB
Project	EMERALD PARK - STAGE 5	Date tested	18/07/18
Location	TARNEIT	Checked by	JHF

Feature	EARTHWORKS	Layer thickness	200 mm	Time: 11:00
----------------	-------------------	-----------------	--------	-------------

Test procedure AS 1289.2.1.1 & 5.8.1

Test No	1	2	3	-	-	-
Location	REFER TO FIGURE 1	REFER TO FIGURE 1	REFER TO FIGURE 1			
Approximate depth below FSL						
Measurement depth <i>mm</i>	175	175	175	-	-	-
Field wet density <i>t/m³</i>	1.82	1.79	1.78	-	-	-
Field moisture content <i>%</i>	29.8	32.0	32.7	-	-	-

Test procedure AS 1289.5.7.1

Test No	1	2	3	-	-	-
Compactive effort	Standard					
Oversize rock retained on sieve <i>mm</i>	19.0	19.0	19.0	-	-	-
Percent of oversize material <i>wet</i>	0	0	0	-	-	-
Peak Converted Wet Density <i>t/m³</i>	1.89	1.81	1.79	-	-	-
Adjusted Peak Converted Wet Density <i>t/m³</i>	-	-	-	-	-	-
Optimum Moisture Content <i>%</i>	30.0	34.0	34.5	-	-	-

Moisture Variation From Optimum Moisture Content	0.0%	1.5% dry	1.5% dry	-	-	-
--	------	-------------	-------------	---	---	---

Density Ratio (R_{HD})	%	96.5	99.0	99.5	-	-	-
---	----------	-------------	-------------	-------------	---	---	---

Material description

No 1 - 3 Clay Fill



The results of the tests, calibrations and/or measurements included in this document are traceable to Australian/National standards. Accredited for compliance to ISO/IEC 17025. Accreditation No 9909

Approved Signatory : Justin Fry



COMPACTION ASSESSMENT

Job No 18417
 Report No 18417/R002
 Date Issued 28/05/2019

CIVIL GEOTECHNICAL SERVICES

6 - 8 Rose Avenue, Croydon 3136

Client	WINSLOW CONSTRUCTORS PTY LTD (CAMPBELLFIELD)	Tested by	JB
Project	EMERALD PARK - STAGE 5	Date tested	25/07/18
Location	TARNEIT	Checked by	JHF

Feature	EARTHWORKS	Layer thickness	200 mm	Time: 11:01
---------	------------	-----------------	--------	-------------

Test procedure AS 1289.2.1.1 & 5.8.1

Test No	4	5	6	7	8	9	
Location	REFER TO FIGURE 1	REFER TO FIGURE 1	REFER TO FIGURE 1	REFER TO FIGURE 1	REFER TO FIGURE 1	REFER TO FIGURE 1	
Approximate depth below FSL							
Measurement depth	mm	175	175	175	175	175	
Field wet density	t/m ³	1.85	1.85	1.81	1.85	1.88	1.83
Field moisture content	%	27.6	29.4	27.8	24.4	30.1	26.6

Test procedure AS 1289.5.7.1

Test No	4	5	6	7	8	9	
Compactive effort	Standard						
Oversize rock retained on sieve	mm	19.0	19.0	19.0	19.0	19.0	19.0
Percent of oversize material	wet	0	0	0	0	0	0
Peak Converted Wet Density	t/m ³	1.88	1.88	1.84	1.88	1.92	1.86
Adjusted Peak Converted Wet Density	t/m ³	-	-	-	-	-	-
Optimum Moisture Content	%	29.5	31.5	30.0	26.5	32.5	29.0

Moisture Variation From Optimum Moisture Content	2.0% dry	2.0% dry	2.0% dry	2.0% dry	2.5% dry	2.5% dry
--	----------	----------	----------	----------	----------	----------

Density Ratio (R _{HD})	%	98.5	98.0	98.5	98.0	98.0	98.5
----------------------------------	---	------	------	------	------	------	------

Material description

No 4 - 9 Clay Fill

AVRLOT HILF V1.10 MAR 13



The results of the tests, calibrations and/or measurements included in this document are traceable to Australian/national standards. Accredited for compliance with ISO/IEC 17025 - Testing

Accreditation No 9909

Approved Signatory : Justin Fry



COMPACTION ASSESSMENT

Job No 18417
 Report No 18417/R003
 Date Issued 17/10/2018

CIVIL GEOTECHNICAL SERVICES

6 - 8 Rose Avenue, Croydon 3136

Client	WINSLOW CONSTRUCTORS PTY LTD (CAMPBELLFIELD)	Tested by	JB
Project	EMERALD PARK - STAGE 5	Date tested	26/07/18
Location	TARNEIT	Checked by	JHF

Feature	EARTHWORKS	Layer thickness	200 mm	Time: 12:30
---------	------------	-----------------	--------	-------------

Test procedure AS 1289.2.1.1 & 5.8.1

Test No		10	11	12	13	14	15
Location		REFER TO FIGURE 1	REFER TO FIGURE 1	REFER TO FIGURE 1	REFER TO FIGURE 1	REFER TO FIGURE 1	REFER TO FIGURE 1
Approximate depth below FSL							
Measurement depth	mm	175	175	175	175	175	175
Field wet density	t/m ³	1.87	1.82	1.88	1.95	1.88	1.91
Field moisture content	%	31.7	21.8	24.3	30.5	27.0	28.9

Test procedure AS 1289.5.7.1

Test No		10	11	12	13	14	15
Compactive effort		Standard					
Oversize rock retained on sieve	mm	19.0	19.0	19.0	19.0	19.0	19.0
Percent of oversize material	wet	0	0	0	0	0	0
Peak Converted Wet Density	t/m ³	1.89	1.85	1.93	1.99	1.91	1.94
Adjusted Peak Converted Wet Density	t/m ³	-	-	-	-	-	-
Optimum Moisture Content	%	31.0	24.0	26.5	31.0	29.5	30.5

Moisture Variation From Optimum Moisture Content	0.5% wet	2.5% dry	2.0% dry	0.5% dry	2.0% dry	1.5% dry
--	----------	----------	----------	----------	----------	----------

Density Ratio (R _{HD})	%	99.0	98.5	97.0	97.5	98.0	98.5
-----------------------------------	---	------	------	------	------	------	------

Material description

No 10 - 15 Clay Fill



The results of the tests, calibrations and/or measurements included in this document are traceable to Australian/National standards. Accredited for compliance to ISO/IEC 17025. Accreditation No 9909

Approved Signatory : Justin Fry



COMPACTION ASSESSMENT

Job No 18417
 Report No 18417/R004
 Date Issued 13/12/2018

CIVIL GEOTECHNICAL SERVICES

6 - 8 Rose Avenue, Croydon 3136

Client	WINSLOW CONSTRUCTORS PTY LTD (CAMPBELLFIELD)	Tested by	BS
Project	EMERALD PARK - STAGE 5	Date tested	21/11/18
Location	TARNEIT	Checked by	JHF

Feature	EARTHWORKS	Layer thickness	300 mm	Time: 14:46
----------------	------------	-----------------	--------	-------------

Test procedure AS 1289.2.1.1 & 5.8.1

Test No	16	17	18	-	-	-
Location	REFER TO FIGURE 1	REFER TO FIGURE 1	REFER TO FIGURE 1			
Approximate depth below FSL						
Measurement depth <i>mm</i>	175	175	175	-	-	-
Field wet density <i>t/m³</i>	1.88	1.88	1.86	-	-	-
Field moisture content <i>%</i>	25.2	24.3	22.2	-	-	-

Test procedure AS 1289.5.7.1

Test No	16	17	18	-	-	-
Compactive effort	Standard					
Oversize rock retained on sieve <i>mm</i>	19.0	19.0	19.0	-	-	-
Percent of oversize material <i>wet</i>	0	0	0	-	-	-
Peak Converted Wet Density <i>t/m³</i>	1.92	1.93	1.91	-	-	-
Adjusted Peak Converted Wet Density <i>t/m³</i>	-	-	-	-	-	-
Optimum Moisture Content <i>%</i>	28.0	27.0	25.0	-	-	-

Moisture Variation From Optimum Moisture Content	2.5% dry	2.5% dry	2.5% dry	-	-	-
--	----------	----------	----------	---	---	---

Density Ratio (R_{HD})	%	97.5	97.5	97.5	-	-	-
--	----------	-------------	-------------	-------------	---	---	---

Material description

No 16 - 18 Clay Fill

AVRLOT HILF V1.10 MAR 13



The results of the tests, calibrations and/or measurements included in this document are traceable to Australian/National standards. Accredited for compliance to ISO/IEC 17025. Accreditation No 9909

Approved Signatory : Justin Fry